

- Coin cell holder for 9 different coin cell types.
- Surface mount type with compact body.
- Heat resistant glass fiber filled LCP for lead free reflow soldering.
- Tape reel packages (-TR models) are available for bulk purchase.
- SMTU1220-G, SMTU1632-G and SMTU2032-1-G are gold plated models.

| Technical Data |
|---------------------------------------|
| Operating temperature: -40°C ~ +100°C |

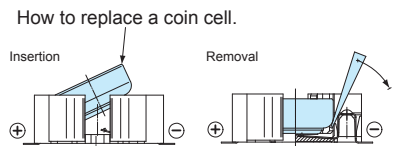

Components

| Holder material | Holder color | Contact material | Contact finish |
|----------------------------------|-----------------------------|------------------|---|
| Glass fiber filled LCP (UL94V-0) | Ivory (Gray for SMTU2-2016) | SUS301 | Battery contact : Nickel plated • Soldered area : Sn plated over nickel Gold plated over nickel (SMTU1220G • 1632-G • 2032-1-G models) |

Product no. / Feature

| Product no. | Matching coin cell | Contact type | Weight (g) | Pack of |
|------------------------|--------------------|-------------------|------------|----------------|
| SMTU357 | LR44 / SR44 | Surface mount x 2 | 0.9 | 1 |
| SMTU1220 | CR1220 | Surface mount x 2 | 0.8 | 1 |
| SMTU1220-G | CR1220 | Surface mount x 2 | 0.8 | 1 |
| SMTU1225 | CR1225 | Surface mount x 2 | 0.7 | 1 |
| SMTU1632 | CR1632 | Surface mount x 2 | 0.8 | 1 |
| SMTU1632-G | CR1632 | Surface mount x 2 | 0.8 | 1 |
| SMTU2-2016 | CR2016×2 *1 | Surface mount x 2 | 1.0 | 1 |
| SMTU2032 | CR2032 | Surface mount x 2 | 1.0 | 1 |
| SMTU2032-1-G | CR2032 | Surface mount x 2 | 1.0 | 1 |
| SMTU2430 | CR2430 | Surface mount x 2 | 1.0 | 1 |
| SMTU2450 | CR2450 *2 | Surface mount x 2 | 1.5 | 1 |
| NEW SMTU2477 | CR2477 *3 | Surface mount x 2 | 1.7 | 1 |
| SMTU357-T | LR44 / SR44 | Surface mount x 2 | — | 50 pcs / tray |
| SMTU1220-TR | CR1220 | Surface mount x 2 | — | 750 pcs / reel |
| SMTU1220-G-TR | CR1220 | Surface mount x 2 | — | 750 pcs / reel |
| SMTU1225-TR | CR1225 | Surface mount x 2 | — | 750 pcs / reel |
| SMTU1632-T | CR1632 | Surface mount x 2 | — | 50 pcs / tray |
| SMTU1632-G-TR | CR1632 | Surface mount x 2 | — | 520 pcs / reel |
| SMTU2032-TR | CR2032 | Surface mount x 2 | — | 485 pcs / reel |
| SMTU2032-1-G-TR | CR2032 | Surface mount x 2 | — | 485 pcs / reel |
| SMTU2430-TR | CR2430 | Surface mount x 2 | — | 490 pcs / reel |
| SMTU2450-TR | CR2450 *2 | Surface mount x 2 | — | 350 pcs / reel |
| NEW SMTU2477-TR | CR2477 *3 | Surface mount x 2 | — | 250 pcs / reel |

*1 • *2 : Some coin cells are not suitable for SMTU2-2016 and SMTU2450. Please refer to the chart below.
To use a non-listed coin cell, please check and confirm before use.
*3 SMTU2477 can only be used with a Renata coin cell.

SMTU-2016 Suitability Chart

| Brand (Product no.) | Suitability |
|---------------------|-------------|
| FDK (CR2016C) | ○ |
| maxell (CR2016 1BS) | ○ |
| MITSUBISHI (CR2016) | ○ |
| Panasonic (CR2016) | × |
| renata (CR2016 MFR) | ○ |
| SONY (CR2016-ECO) | ○ |
| TOSHIBA (CR2016EC) | ○ |

Reason for × : Coin cell is too thin.

SMTU2450 Suitability Chart

| Brand (Product no.) | Suitability |
|----------------------|-------------|
| FDK (CR2450C) | ○ |
| maxell (CR2450) | ○ |
| maxell (CR2450HR) | × |
| maxell (CR2450HR-Ex) | × |
| MITSUBISHI (CR2450B) | ○ |
| Panasonic (CR2450) | × |
| renata (CR2450N) | ○ |
| SANYO (CR2450-1BP) | ○ |
| SONY (CR2450B-ECO) | ○ |

Reason for × : Coin cell shape does not fit.

SMTU2477 can only be used with a Renata coin cell.

SUTU2477 is exclusively designed for use with a Renata CR2477N coin cell.

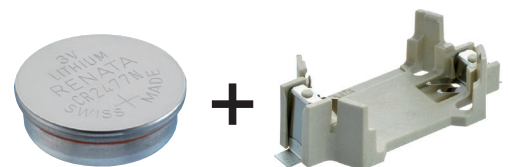

SMTU dimensions

■ DXF/DWG/PDF drawings available on our website.

SMTU357

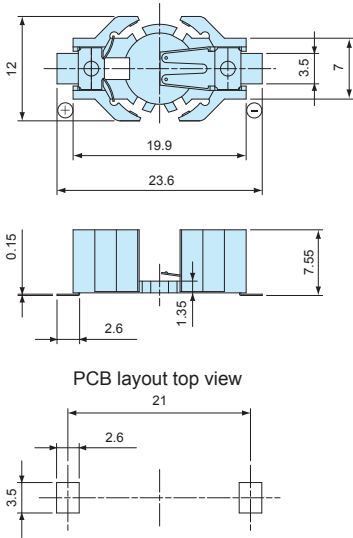

SMTU1220 / 1220-G

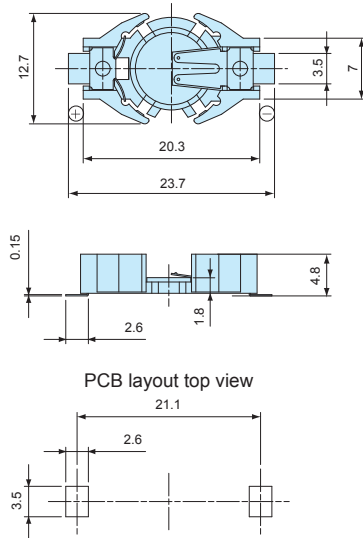

SMTU1225

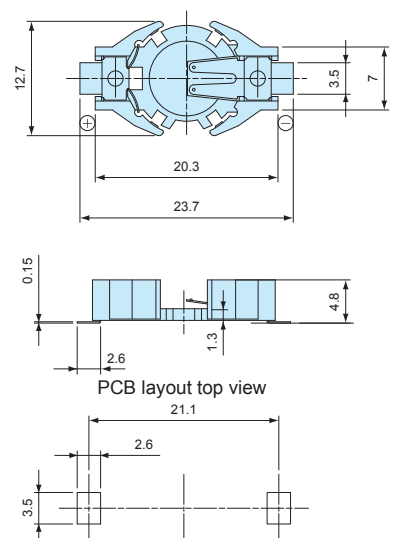

SMTU1632 / 1632-G

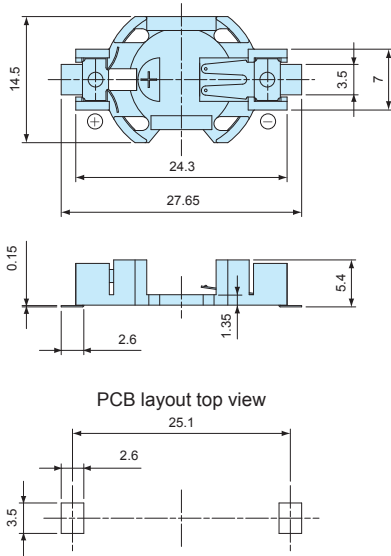

SMTU2032 / 2032-1-G / 2-2016

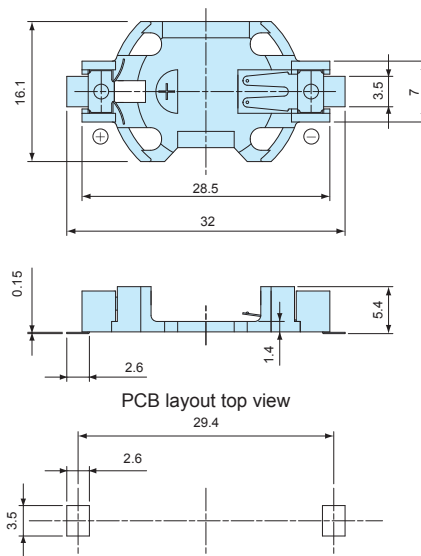

■ External dimensions of SMTU2032 and SMTU2-2016 are similar. However, each holder has a different positive contact and holder color. Refer to the images below.

SMTU2032

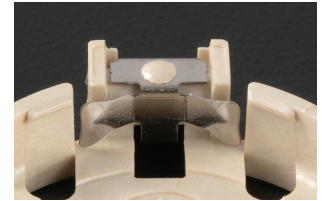

SMTU2-2016

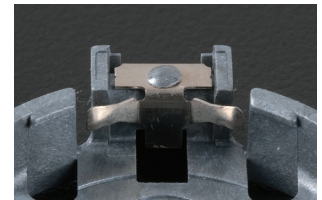

SMTU2430

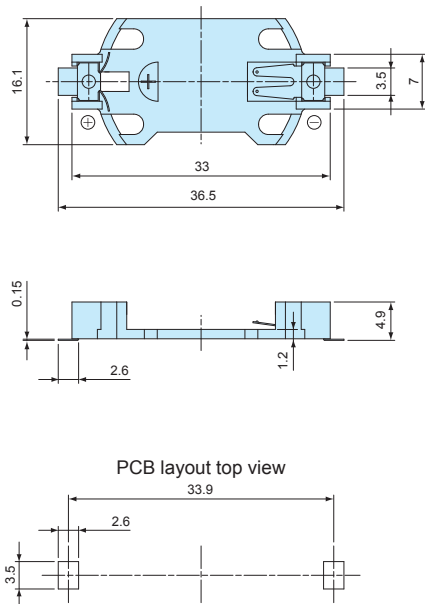

SMTU2450

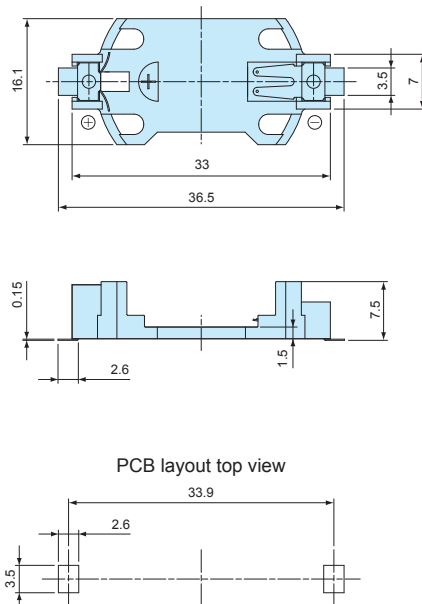

SMTU2477

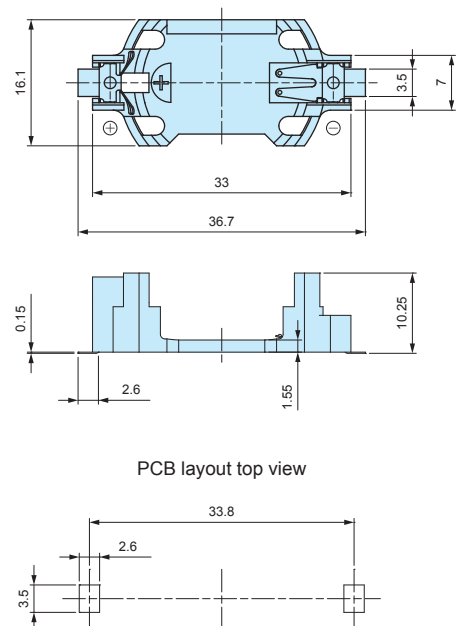

Tape dimensions

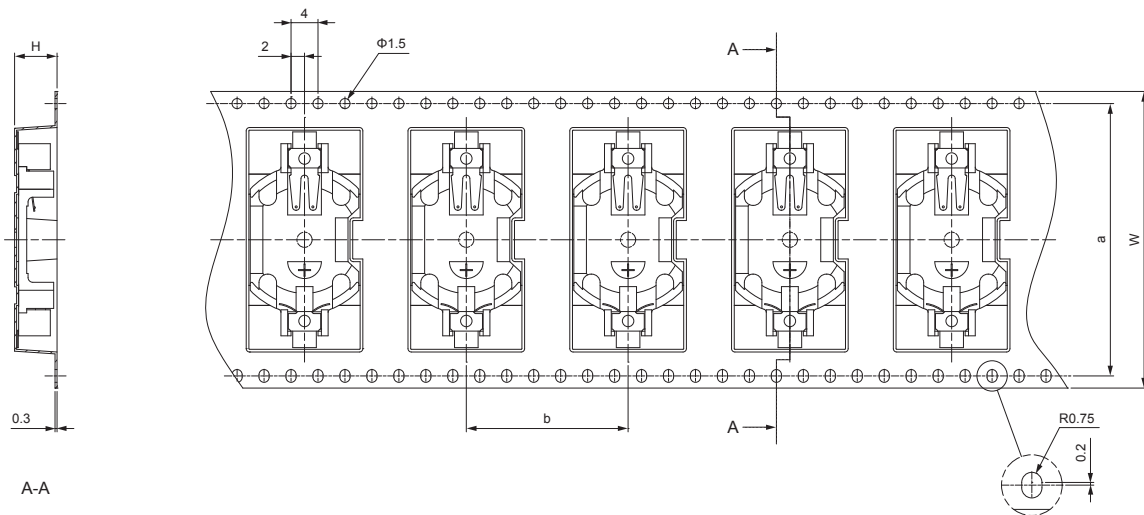

※Holder storage spacing will vary depending on model.

| Product no. | W | H | a | b |
|-----------------|----|------|------|----|
| SMTU1220-TR | 44 | 6 | 40.4 | 16 |
| SMTU1220-G-TR | 44 | 6 | 40.4 | 16 |
| SMTU1225-TR | 44 | 6 | 40.4 | 16 |
| SMTU1632-G-TR | 44 | 6.1 | 40.4 | 20 |
| SMTU2032-TR | 44 | 6.3 | 40.4 | 24 |
| SMTU2032-1-G-TR | 44 | 6.3 | 40.4 | 24 |
| SMTU2430-TR | 56 | 6 | 52.4 | 24 |
| SMTU2450-TR | 56 | 8.5 | 52.4 | 24 |
| SMTU2477-TR | 56 | 10.8 | 52.4 | 24 |

Reel dimensions

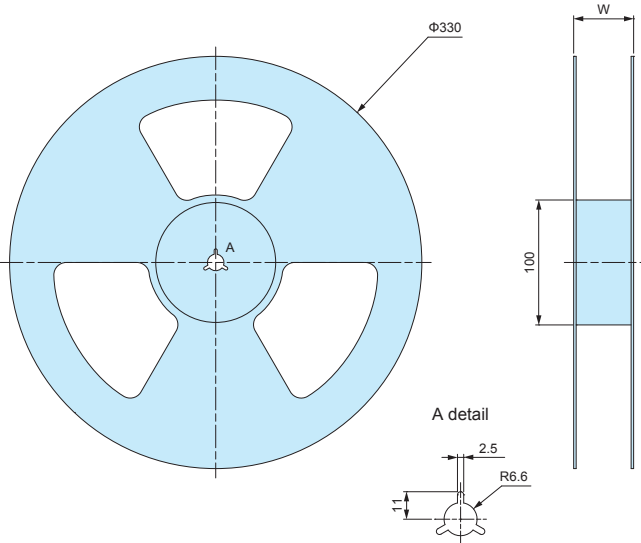

| Product no. | Pcs / Reel | w |
|-----------------|------------|------|
| SMTU1220-TR | 750 | 48.5 |
| SMTU1220-G-TR | | |
| SMTU1225-TR | 750 | 48.5 |
| SMTU1632-G-TR | 520 | 48.5 |
| SMTU2032-TR | 485 | 48.5 |
| SMTU2032-1-G-TR | | |
| SMTU2430-TR | 490 | 61.5 |
| SMTU2450-TR | 350 | 61.5 |
| SMTU2477-TR | 250 | 61.5 |



- Coin cell holder for 8 different coin cell types.
- Through-hole type with pins in a compact body.
- Heat resistant glass fiber filled LCP for lead-free reflow soldering.

| Technical Data |
|---------------------------------------|
| Operating temperature: -40°C ~ +100°C |

How to replace a coin cell.

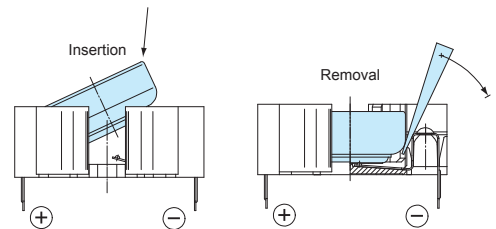

Components

| Holder material | Holder color | Contact material | Contact finish |
|----------------------------------|--------------|------------------|---------------------------------------|
| Glass fiber filled LCP (UL94V-0) | Ivory | SUS301 | Nickel plated • Sn plated over nickel |

Battery contact : Nickel plated • Soldered area : Sn plated over nickel

Product no. / Feature

| Product no. | Matching coin cell | Contact type | Weight (g) | Pack of |
|---------------------|-----------------------|------------------|------------|---------------|
| HU357 | LR44/SR44 | Through hole x 3 | 0.8 | 1 |
| HU1220 | CR1220 | Through hole x 3 | 0.8 | 1 |
| HU1225 | CR1225 | Through hole x 3 | 0.7 | 1 |
| HU1632 | CR1632 | Through hole x 3 | 0.8 | 1 |
| HU2032 | CR2032 | Through hole x 3 | 1.0 | 1 |
| HU2430 | CR2430 | Through hole x 3 | 1.1 | 1 |
| HU2450 | CR2450 * ¹ | Through hole x 3 | 1.5 | 1 |
| NEW HU2477 | CR2477 * ² | Through hole x 3 | 1.7 | 1 |
| HU1220-T | CR1220 | Through hole x 3 | — | 50 pcs / tray |
| HU1225-T | CR1225 | Through hole x 3 | — | 50 pcs / tray |
| HU1632-T | CR1632 | Through hole x 3 | — | 50 pcs / tray |
| HU2032-T | CR2032 | Through hole x 3 | — | 50 pcs / tray |
| HU2430-T | CR2430 | Through hole x 3 | — | 50 pcs / tray |
| HU2450-T | CR2450 * ¹ | Through hole x 3 | — | 50 pcs / tray |
| NEW HU2477-T | CR2477 * ² | Through hole x 3 | — | 50 pcs / tray |

*¹: Some coin cells are not suitable for HU2450. Please refer to the chart below.

To use a non-listed coin cell, please check and confirm before use.

*² HU2477 can only be used with a Renata coin cell.

*¹ HU2450 Suitability Chart

| Brand (Product no.) | Suitability |
|----------------------|-------------|
| FDK (CR2450C) | ○ |
| maxell (CR2450) | ○ |
| maxell (CR2450HR) | × |
| maxell (CR2450HR-Ex) | × |
| mitsubishi (CR2450B) | ○ |
| Panasonic (CR2450) | × |
| renata (CR2450N) | ○ |
| SANYO (CR2450-1BP) | ○ |
| SONY (CR2450B-ECO) | ○ |

Reason for X : Coin cell shape does not fit.

*² HU2477 can only be used with a Renata coin cell.

HU2477 is exclusively designed for use with a Renata CR2477N coin cell.

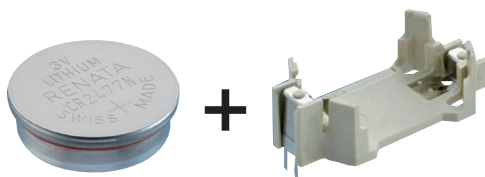

HU dimensions

■ DXF/DWG/PDF drawings available on our website.

HU357

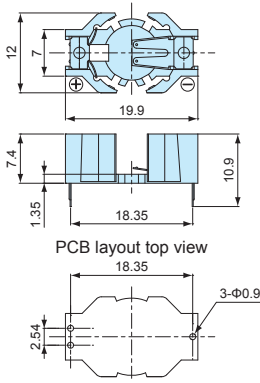

HU1220

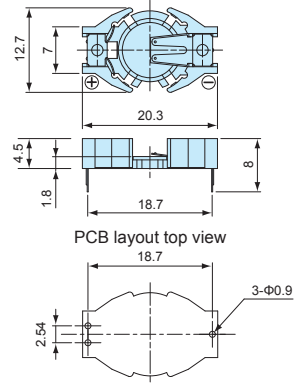

HU1225

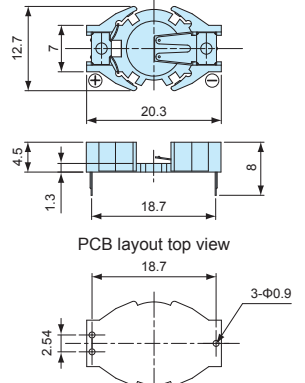

HU1632

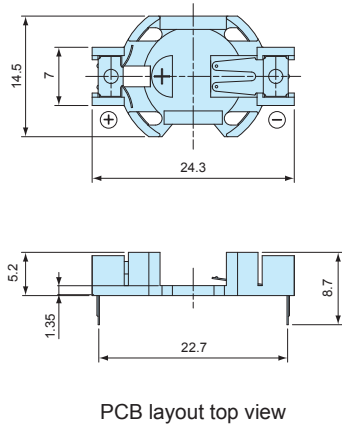

HU2032

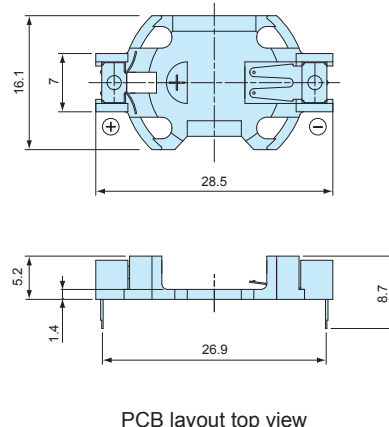

HU2430

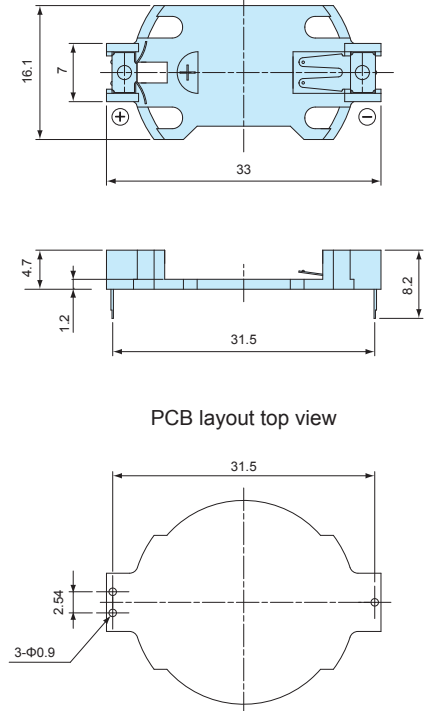

HU2450

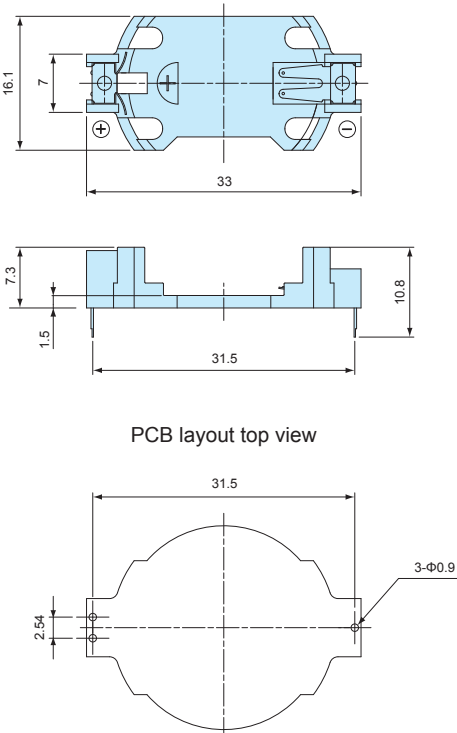

HU2477

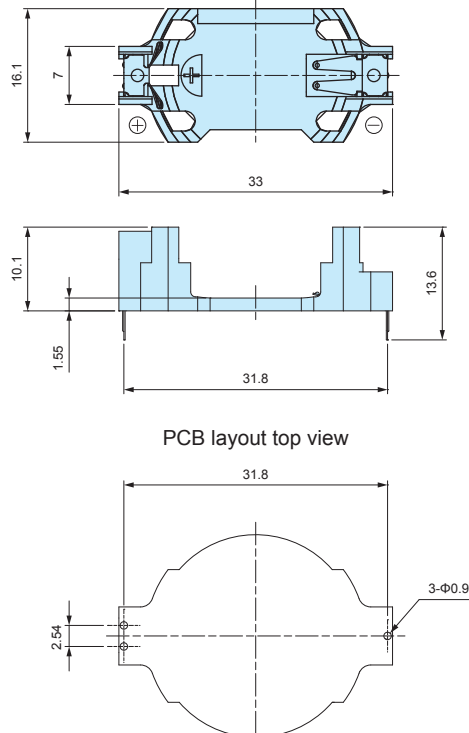

PB621

ML621 • SR621 SMALL BATTERY HOLDER



■ DXF/DWG/PDF drawings available on our website.

Technical Data

Operating temperature: -25°C ~ +85°C

- Heat resistant glass fiber filled LCP for lead free reflow soldering.

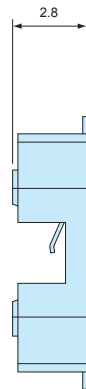
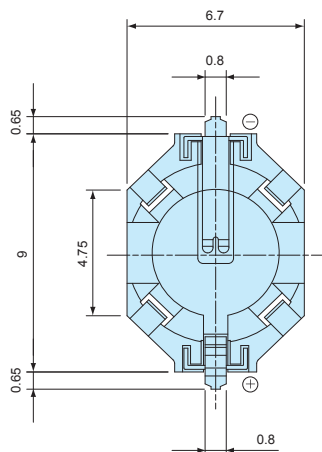

PCB layout top view

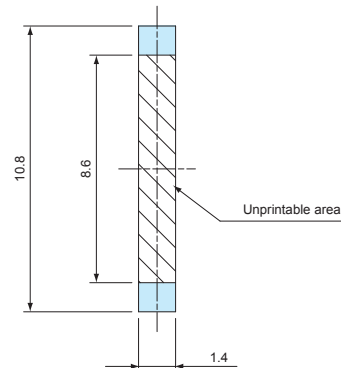

Components

| Holder material | Holder color | Contact material | Contact finish |
|----------------------------------|--------------|------------------|----------------|
| Glass fiber filled LCP (UL94V-0) | Ivory | Copper alloy | Gold plated |

Product no. / Feature

| Product no. | Matching battery | Contact type | Weight (g) | Pack of |
|-------------|------------------|-------------------|------------|---------|
| PB621 | ML621 / SR621 | Surface mount x 2 | 0.1 | 10 |

NOTE

Be careful not to damage the holder when removing the battery without tools. Recommended to use a fine tipped stick or a flat head screwdriver to remove the battery.

How to replace a coin cell.

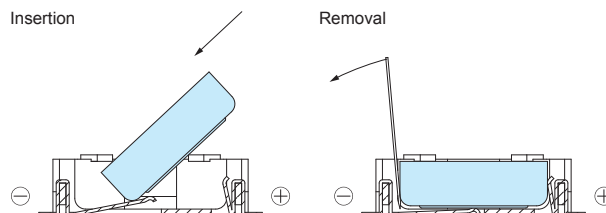

PD SERIES

BUTTON BATTERY HOLDER



■ DXF/DWG/PDF drawings available on our website.

Technical Data

Operating temperature: -40°C ~ +80°C

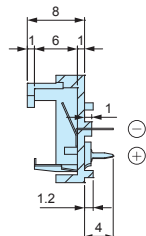
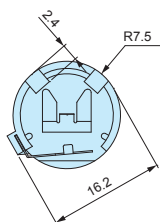

Installation hole layout

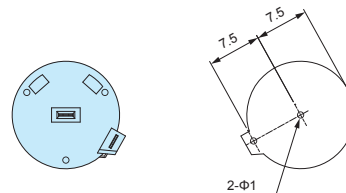

Components

| Holder material | Holder color | Contact material | Contact finish |
|-----------------|--------------|------------------|----------------|
| PBT (UL94V-0) | Black | Phosphor bronze | Sn plated |

NOTE

Insert battery fully in until it is completely flat, otherwise there may be a risk of short-circuiting.

Product no. / Feature

| Product no. | Matching battery | Contact type | Weight (g) | Pack of |
|-------------|------------------|----------------------|------------|---------|
| PD23 | LR44 / SR44 | Through hole pin x 2 | 0.7 | 1 |
| PD23-T | LR44 / SR44 | Through hole pin x 2 | — | 100 |

BCR SERIES

CR2032 COIN CELL HOLDER

■ DXF/DWG/PDF drawings available on our website.

BCR20H4

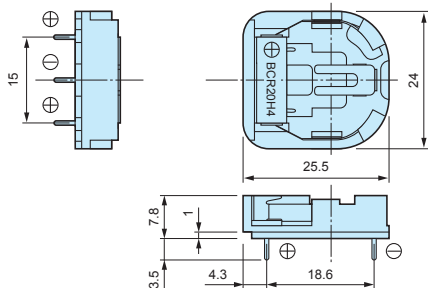
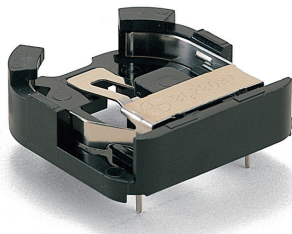

Installation hole layout

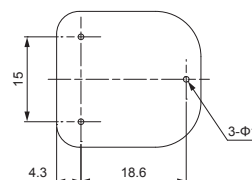

BCR20H5

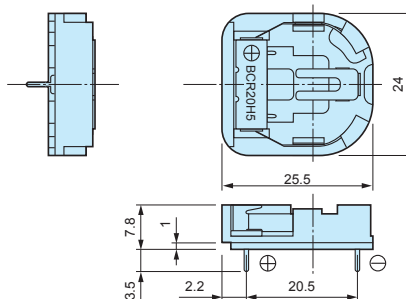
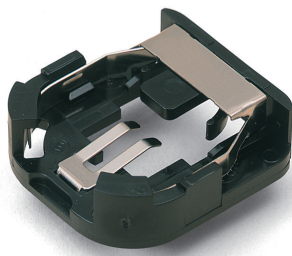

Installation hole layout

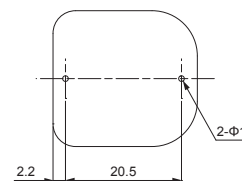

BCR20V4

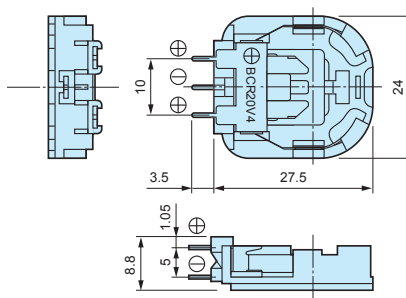
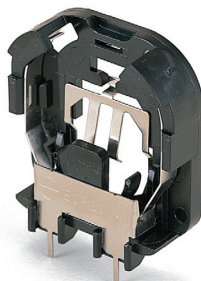

Installation hole layout

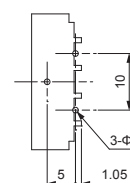

Components

| Holder material | Holder color | Contact material | Contact finish |
|-----------------|--------------|------------------|----------------|
| PAR | Black | Stainless steel | Nickel plated |

Technical Data

Operating temperature: -10°C ~ +85°C

Product no. / Feature

| Product no. | Matching battery | Contact type | Weight (g) | Pack of |
|-------------|------------------|------------------|------------|-----------------------|
| BCR20H4 | CR2032 | Through hole x 3 | 2.0 | 1 |
| BCR20H5 | CR2032 | Through hole x 2 | 2.0 | 1 |
| BCR20V4 | CR2032 | Through hole x 3 | 2.0 | 1 |
| BCR20H4-T | CR2032 | Through hole x 3 | — | 100 (20 pcs tray x 5) |
| BCR20H5-T | CR2032 | Through hole x 2 | — | 100 (20 pcs tray x 5) |
| BCR20V4-T | CR2032 | Through hole x 3 | — | 100 (20 pcs tray x 5) |

BH-50N SERIES

CR2450 COIN CELL HOLDER

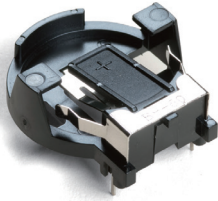

| Technical Data |
|--------------------------------------|
| Operating temperature: -20°C ~ +70°C |

Components

| Holder material | Holder color | Contact material | Contact finish |
|-------------------------------|--------------|------------------|----------------|
| Polyphenylene oxide (UL94V-0) | Black | Stainless steel | Nickel plated |

Product no. / Feature

| Product no. | Battery | Contact type | Weight (g) | Pack of |
|-------------|---------|------------------|------------|---------------|
| BH-50N | CR2450 | Through hole x 3 | 2.7 | 1 |
| BH-50N-T | CR2450 | Through hole x 3 | — | 50 pcs / tray |

■ DXF/DWG/PDF drawings available on our website.

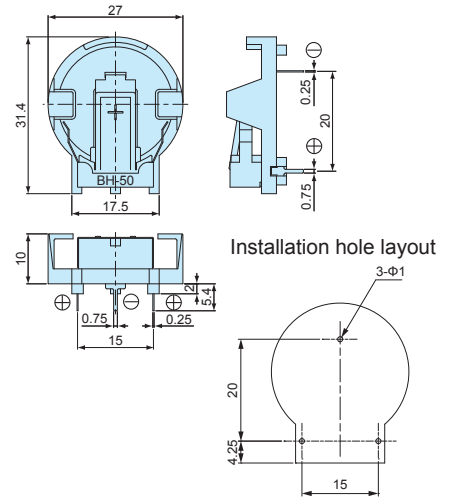

BV-50N SERIES

CR2450 VERTICAL COIN CELL HOLDER



| Technical Data |
|--------------------------------------|
| Operating temperature: -20°C ~ +70°C |

Components

| Holder material | Holder color | Contact material | Contact finish |
|-------------------------------|--------------|------------------|----------------|
| Polyphenylene oxide (UL94V-0) | Black | Stainless steel | Nickel plated |

Product no. / Feature

| Product no. | Battery | Contact type | Weight (g) | Pack of |
|-------------|---------|------------------|------------|---------------|
| BV-50N | CR2450 | Through hole x 3 | 2.7 | 1 |
| BV-50N-T | CR2450 | Through hole x 3 | — | 50 pcs / tray |

■ DXF/DWG/PDF drawings available on our website.

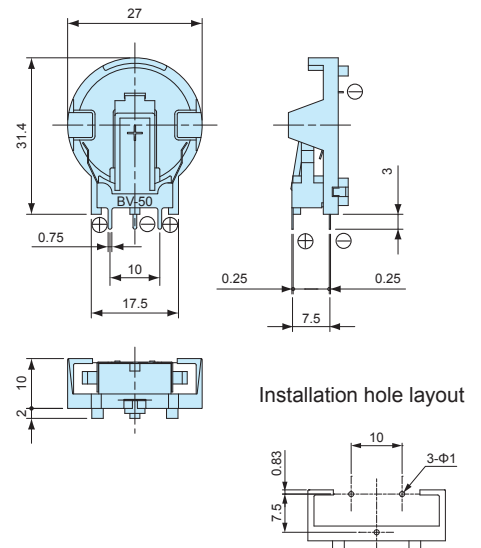

CH74 SERIES

CR2032 VERTICAL COIN CELL HOLDER



| Technical Data |
|--------------------------------------|
| Operating temperature: -40°C ~ +80°C |

Components

| Holder material | Holder color | Contact material | Contact finish |
|--------------------|--------------|------------------|----------------|
| Nylon 66 (UL94V-0) | Black | Phosphor bronze | Sn plated |

Product no. / Feature

| Product no. | Battery | Contact type | Weight (g) | Pack of |
|---------------|---------|------------------|------------|---------------|
| CH74-2032LF | CR2032 | Through hole x 3 | 1.8 | 1 |
| CH74-2032LF-T | CR2032 | Through hole x 3 | — | 75 pcs / tray |

■ DXF/DWG/PDF drawings available on our website.

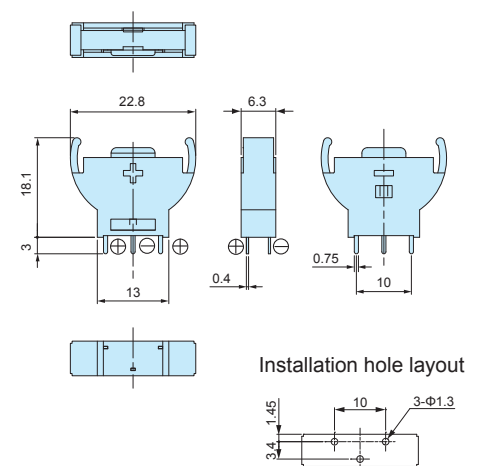

CST SERIES

CR2032 BATTERY CONTACT



■ Material : SUS304 / Nickel plated

- Battery contact for CR2032 coin cell.
- "CR2032" and "⊖" indicators are engraved on the negative side.
- Use with enclosures that utilizes CR2032 coin cells.

Product no. / Feature

| Product no. | Matching coin cell | Contact type | Weight (g) | Pack of |
|-------------|--------------------|------------------|------------|---------|
| CST-2032P | CR2032 | Through hole x 2 | 0.1 | 10 |
| CST-2032M | CR2032 | Through hole x 2 | 0.2 | 10 |

■ DXF/DWG/PDF drawings available on our website.

CST-2032P

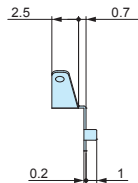
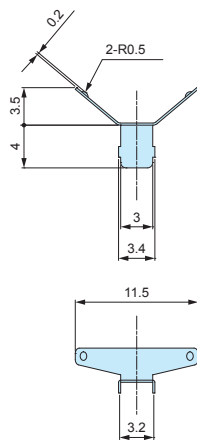

CST-2032M

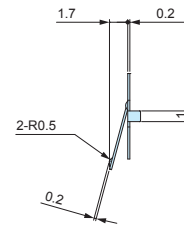
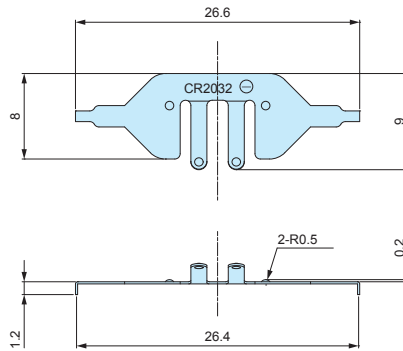

Recommended PCB hole layout

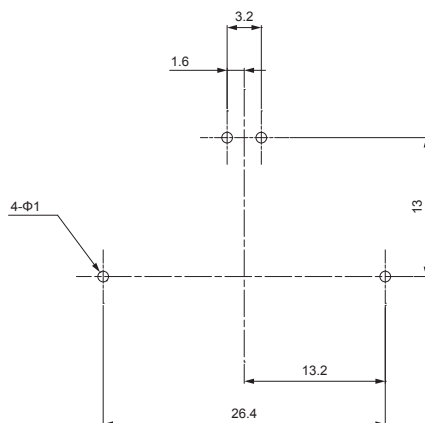

Mount Example

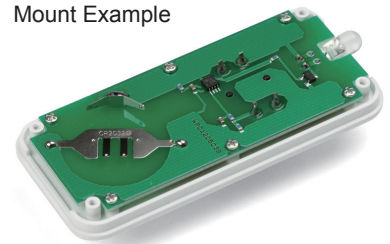

■ Refer to the mount example for mounting direction of contacts.



- Material / Finish : Phosphor bronze / Nickel plated
- Metal coin cell holder.
- Tape reel packages (-TR models) are available for bulk purchase.
- Make a negative pole on the PCB and place or solder a plate onto it. BK2032M negative contact can be used for SMTM2032 and BK-888.

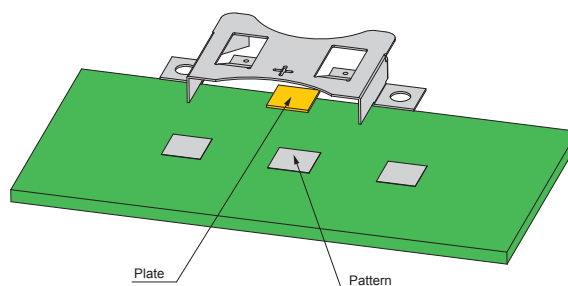

Product no. / Feature

| Product no. | Matching coin cell | Contact type | Weight (g) | Pack of |
|------------------------|--------------------|-------------------|------------|------------------|
| BK-879 | SR621/ML621 | Surface mount x 2 | 0.2 | 10 |
| BK-5091 | LR44 | Through hole x 2 | 0.5 | 10 |
| NEW SMTM1225 | CR1220/CR1225 | Surface mount x 2 | 0.4 | 10 |
| BK-890 | CR1220/CR1225 | Through hole x 2 | 0.4 | 10 |
| SMTM1632 | CR1632 | Surface mount x 2 | 0.7 | 10 |
| BK-869 | CR1620/CR1632 | Through hole x 2 | 0.7 | 10 |
| BK-5067 | CR2016 | Surface mount x 2 | 0.8 | 10 |
| SMTM2032 | CR2032/CR2025 | Surface mount x 2 | 0.9 | 10 |
| BK-888 | CR2032/CR2025 | Through hole x 2 | 0.9 | 10 |
| NEW SMTM1225-TR | CR1220/CR1225 | Surface mount x 2 | — | 1,000 pcs / reel |
| SMTM1632-TR | CR1632 | Surface mount x 2 | — | 700 pcs / reel |
| SMTM2032-TR | CR2032/CR2025 | Surface mount x 2 | — | 600 pcs / reel |

SMTM • BK dimensions

DXF/DWG/PDF drawings available on our website.

BK-879

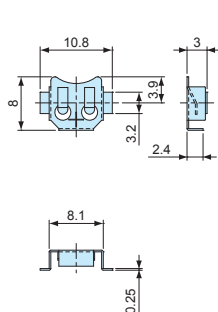

PCB layout top view

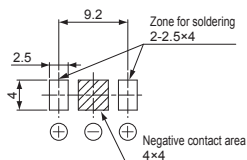

BK-5091

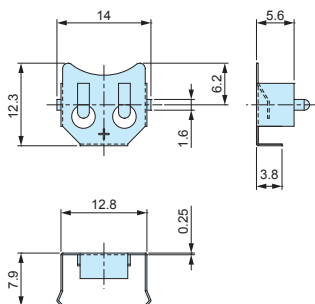

PCB layout top view

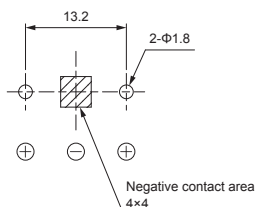

SMTM1225

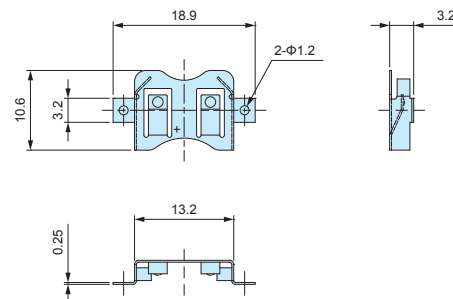

PCB layout top view

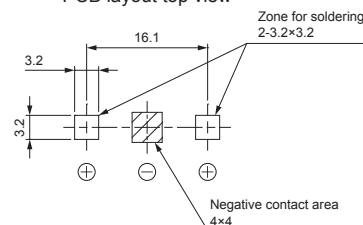

BK-890

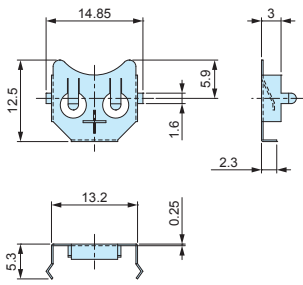

PCB layout top view

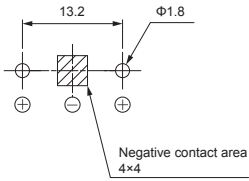

SMTM1632

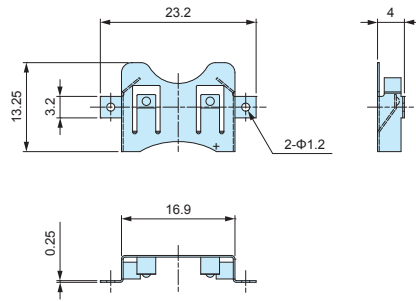

PCB layout top view

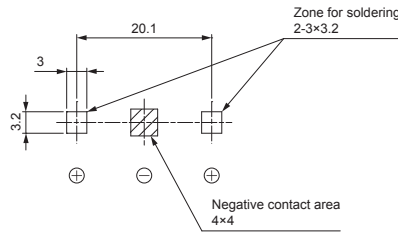

BK-869

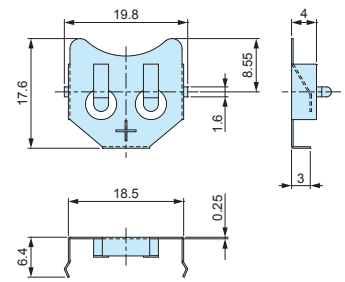

PCB layout top view

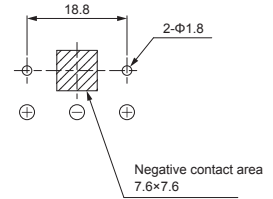

BK-5067

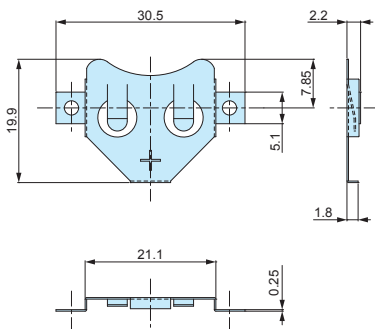

PCB layout top view

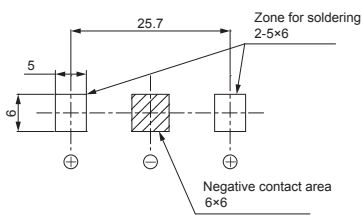

SMTM2032

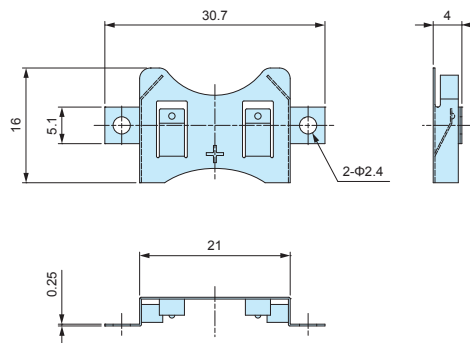

PCB layout top view

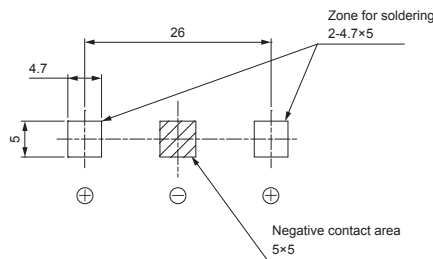

BK-888

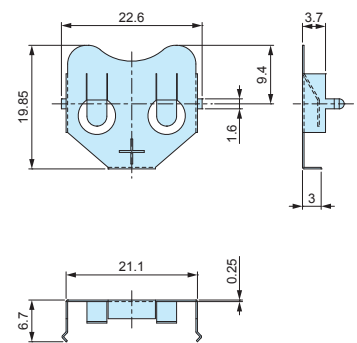

PCB layout top view

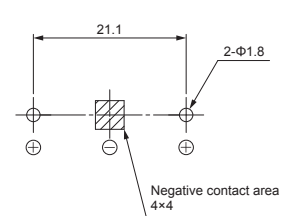

Tape dimensions

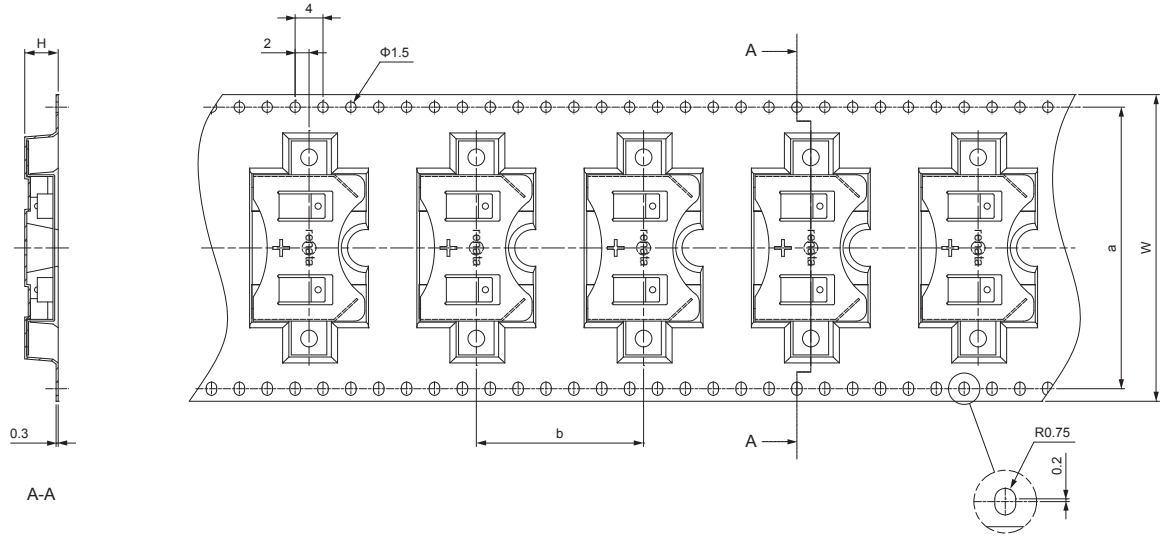

※Holder storage spacing will vary depending on model.

| Product no. | W | H | a | b |
|-------------|----|-----|------|----|
| SMTM1225-TR | 32 | 3.8 | 28 | 16 |
| SMTM1632-TR | 44 | 4.5 | 40.4 | 20 |
| SMTM2032-TR | 44 | 4.8 | 40.4 | 24 |

Reel dimensions

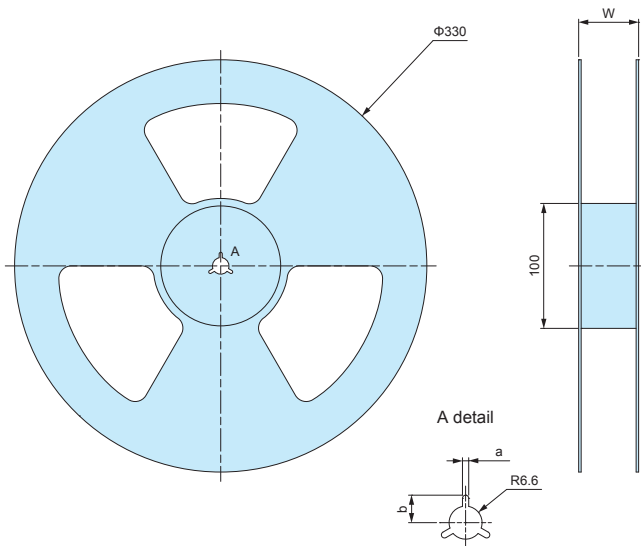

| Product no. | Pcs / Reel | w | a | b |
|-------------|------------|------|-----|------|
| SMTM1225-TR | 1,000 | 38.5 | 2.1 | 10.4 |
| SMTM1632-TR | 700 | 50.5 | 2.1 | 10.4 |
| SMTM2032-TR | 600 | 48.5 | 2.4 | 11 |

BK-2032M

NEGATIVE COIN CELL CONTACT for CR2032

■ DXF/DWG/PDF drawings available on our website.

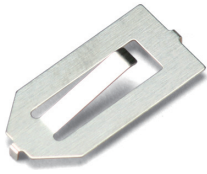

- Material / Finish : Phosphor bronze / Nickel plated
- Negative contact for CR2032 coin cell.
- Suitable to be used with SMTM2032 or BK-888 holders.
- Cut area will have base material exposed (unfinished).

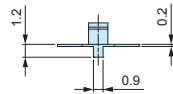
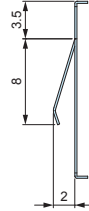
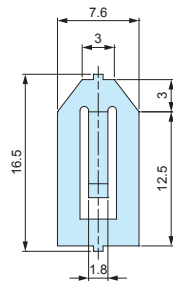

Installation hole layout

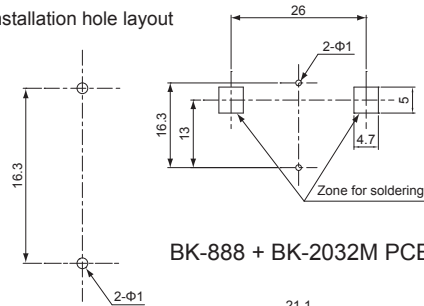

SMTM + BK-2032M PCB layout top view

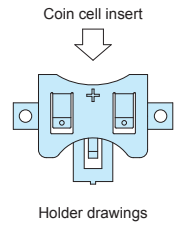

BK-888 + BK-2032M PCB layout top view

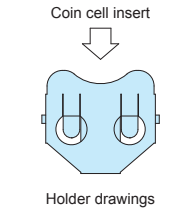
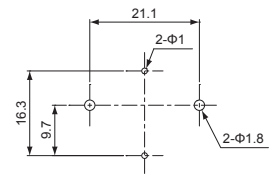

■ Recommended PCB thickness for installation is 1.0mm or thinner.

Product no. / Feature

| Product no. | Matching coin cell | Contact type | Weight (g) | Pack of |
|-------------|--------------------|------------------|------------|---------|
| BK-2032M | CR2032 | Through hole x 2 | 0.2 | 10 |