

PMB-1**POLE MOUNTING BRACKET**

Installation example

■ DXF/DWG/PDF drawings available on our website.

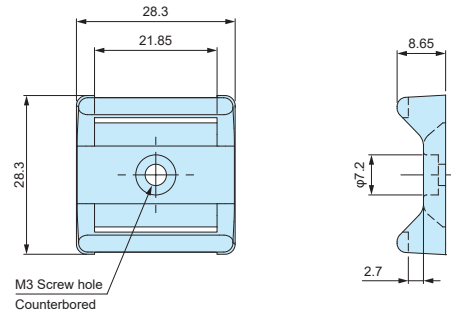

- Small size pole mounting bracket suitable for indoor use.
- Installation screws (M3 size) are separately sold.
See page HES • HOS • MT for compatible MT3-4 screws.
- Minimum applicable pole diameter is $\Phi 35$.
- Use SNB • PKB • SCT mounting belt to install onto a pole.

Product no. / Details

■ Material / Color : PA66+GF(UL94HB) / Black

Product no.	Maximum load (kg)	Weight (g)	Pack of
PMB-1	1	3 (1 piece)	2

LPZA-1**RIGHT ANGLE PCB STANDOFF**

Installation example

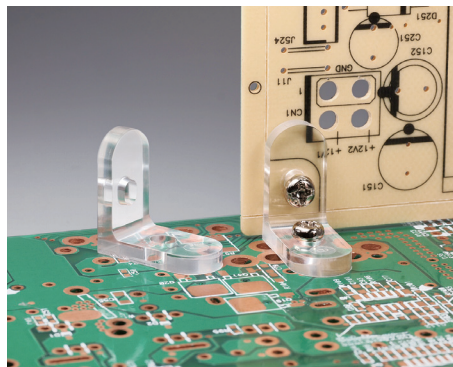

■ DXF/DWG/PDF drawings available on our website.

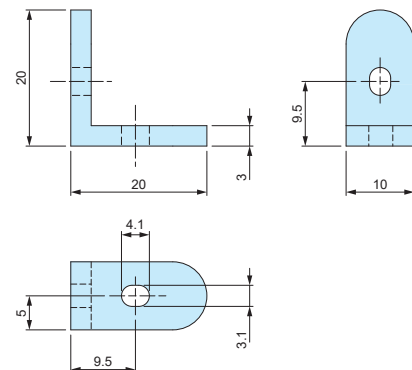

- Right angle standoff for mounting PCB vertically.
- Installation screws (M3 size) are separately sold.
See page HES • HOS • MT for compatible MT3-8 screws.

Product no. / Details

Product no.	Material	Color	Weight (g)	Pack of
LPZA-1	PC (UL94V-2)	Transparent	1 (1 piece)	10

PLCC-3**POWER OUTLET PLUG COVER**

Installation example



■ DXF/DWG/PDF drawings available on our website.

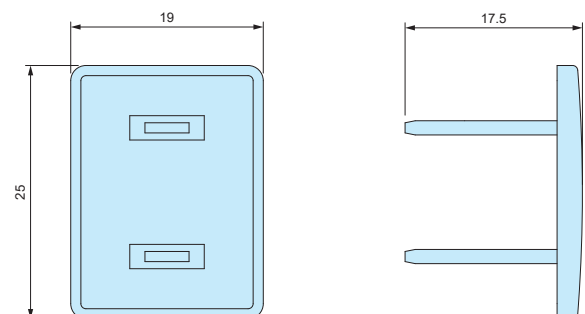

- Plug cover for 100V outlet.

Product no. / Details

Product no.	Material	Color	Weight (g)	Pack of
PLCC-3	ABS (UL94HB)	Black	1 (1 piece)	5

WPMB-M4-3 series**POLE MOUNTING BRACKET**

- Pole mount bracket made from weather resistant ASA material.
- Suitable for both vertical and horizontal mounting.
- IPX7 protection can be maintained through the use of sealing washers.
- Hole milling is required for bracket installation.
- Pole mount is possible with the use of PKB series mounting belt. (see page 324 for PKB series)

WPMB-M4-3 dimensions

■ DXF/DWG/PDF/STP drawings available on our website.

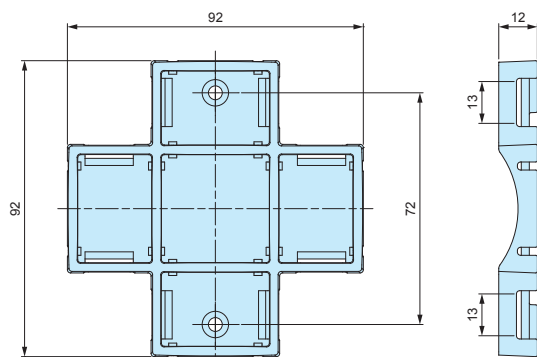
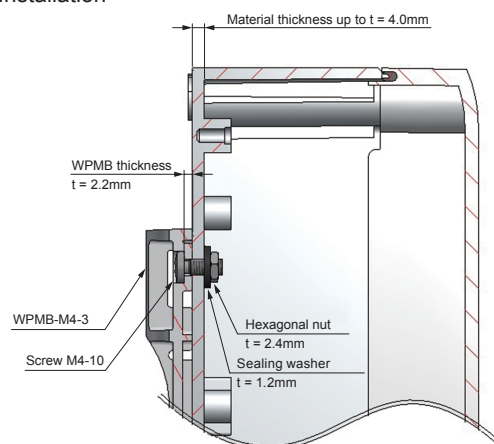
**Installation****Components**

No.	Part name	Pcs	Material	Color / Finish
1	Bracket	1	ASA UL94HB	White gray • Dark gray
2	Sealing washer	2	NBR, SPCC	Black
3	Screw (M4-10 Pan head)	2	Stainless steel	Unfinished
4	Hexagonal nut (M4 - JIS Type 3)	2	Stainless steel	Unfinished

Product no. / Dimensions

Product no.		Material thickness to install	Recommended torque	Max load (kg)	Weight (g)
● White gray	● Dark gray				
WPMB-M4-3G	WPMB-M4-3D	Up to t = 4.0mm	0.45N • m	5	26.5

■ Recommended torque listed is for reference only; actual may differ. Assemble after testing torque.

PKB series**POLE MOUNTING BELT**

PKB-10PM, 10P



PKB-10S, 20S

- Pole mounting belt for attachment of enclosures with suitable pole mount brackets or construction onto poles.
- Designed for one time use only (not reusable).
- Strong stainless steel clamping type and easy installation plastic type are available.

PKB dimensions

■ DXF/DWG/PDF drawings available on our website.

PKB-10PM, 10P

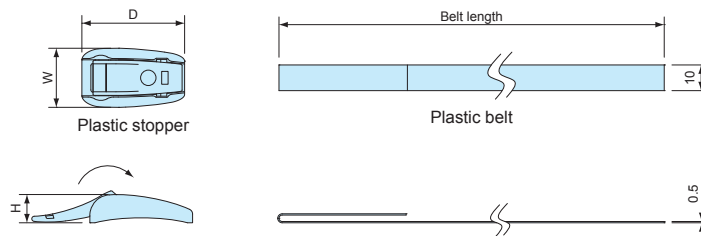

PKB-10S

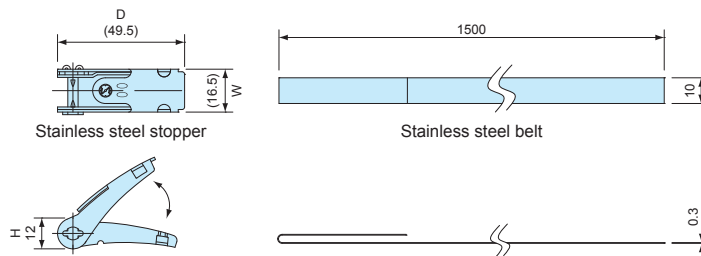

PKB-20S

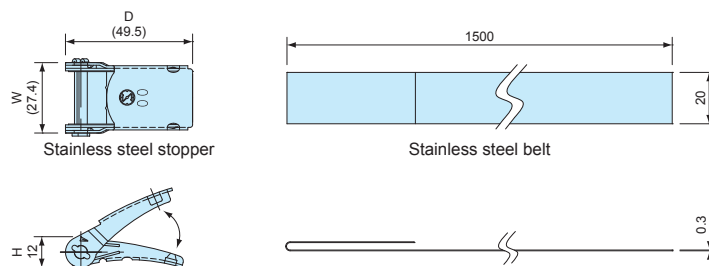
**Components**

No.	Part name	Material	Color / Finish
1	Stopper	Stainless steel SUS304 • POM	Barrel finish • Black
2	Belt	Stainless steel SUS430 • PET	Bright annealed finish • Gray

Product no. / Dimensions

Product no.	W	D	H	Belt length	Belt material	Tensile strength (horizontal)	Weight (g)	Pack of
PKB-10PM	24	23	11	500 mm	PET	0.8kN	14	2
PKB-10PM	23	40	11	1,500 mm	PET	1.3kN	31.8	2
PKB-10S	16.5	49.5	12	1,500 mm	Stainless steel SUS304	1.4kN	101.6	2
PKB-20S	27.4	49.5	12	1,500 mm	Stainless steel SUS430	2.9kN	182.2	2