

PMB-1**POLE MOUNTING BRACKET**

Installation example

■ DXF/DWG/PDF drawings available on our website.

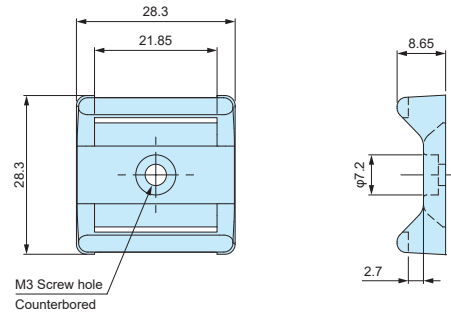

- Small size pole mounting bracket suitable for indoor use.
- Installation screws (M3 size) are separately sold.
See page HES • HOS • MT for compatible MT3-4 screws.
- Minimum applicable pole diameter is $\Phi 35$.
- Use SNB • PKB • SCT mounting belt to install onto a pole.

Product no. / Details

■ Material / Color : PA66+GF(UL94HB) / Black

Product no.	Maximum load (kg)	Weight (g)	Pack of
PMB-1	1	3 (1 piece)	2

LPZA-1**RIGHT ANGLE PCB STANDOFF**

Installation example

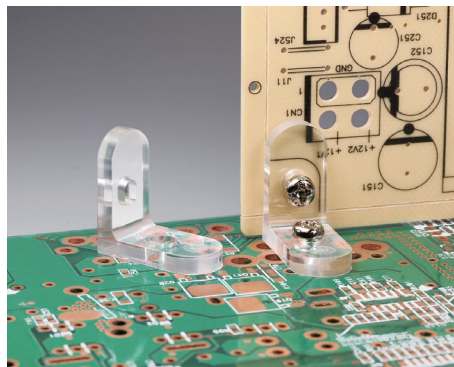

■ DXF/DWG/PDF drawings available on our website.

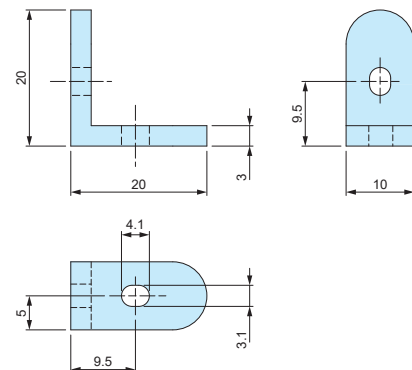

- Right angle standoff for mounting PCB vertically.
- Installation screws (M3 size) are separately sold.
See page HES • HOS • MT for compatible MT3-8 screws.

Product no. / Details

Product no.	Material	Color	Weight (g)	Pack of
LPZA-1	PC (UL94V-2)	Transparent	1 (1 piece)	10

PLCC-3**POWER OUTLET PLUG COVER**

Installation example



■ DXF/DWG/PDF drawings available on our website.

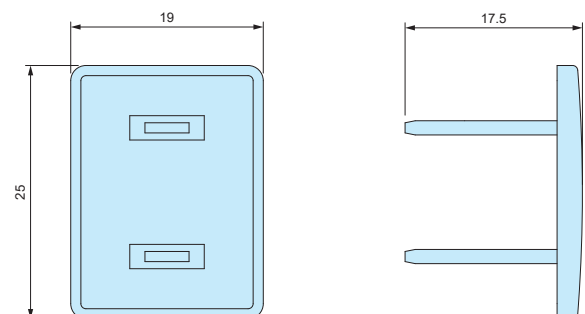

- Plug cover for 100V outlet.

Product no. / Details

Product no.	Material	Color	Weight (g)	Pack of
PLCC-3	ABS (UL94HB)	Black	1 (1 piece)	5