

**HSTP** SERIES

**SHOULDER STRAP**



**Product no. / Feature**

Product no.	Weight (g)	Quantity
HSTP1000	129	1

- Hole milling is required on the case for shoulder strap installation.
- Recommended hole for installation is  $\phi 6.2\text{mm}$ .

**ML** SERIES

**COLOR LATCH for MAXI**

- Replacement latch for MAXI case.



**How to remove latch**

Hold the case and pull the latch.



**How to install latch**

Hold the case, insert thinner side first, and push the opposite side in.

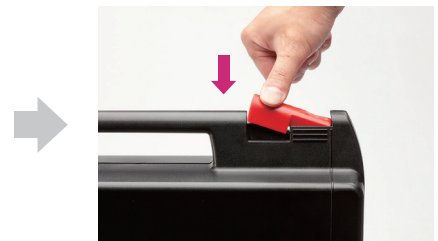
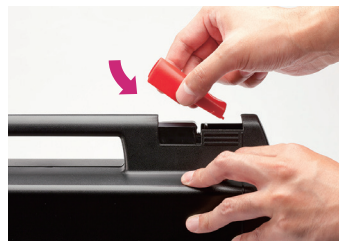

**Product no. / Suitable case**

Product no.							Suitable case	Quantity
● Black	● Marine	● Yellow	● Orange	● Red	● Light gray	● Gray		
ML-SB	ML-SM	ML-SY	ML-SO	ML-SR	ML-SL	ML-SG	MAXI 252307 B ~ MAXI 292614 B	2
ML-LB	ML-LM	ML-LY	ML-LO	ML-LR	ML-LL	ML-LG	MAXI 353106 B ~ MAXI 544521 B	2