

# LCT·LCS·LC·LCE HAND-HELD PLASTIC CASE

Hand-held case suitable for industrial measuring equipments, wireless communication devices and medical equipments.

8 different sizes and 9 different battery compartment types are available for LC plastic case.

LCS series comes with 7 silicone cover colors for selection.

LCT series is selectable in 5 different rugged shock-proof silicone cover colors.

## LCT Plastic case with shock-proof silicone cover

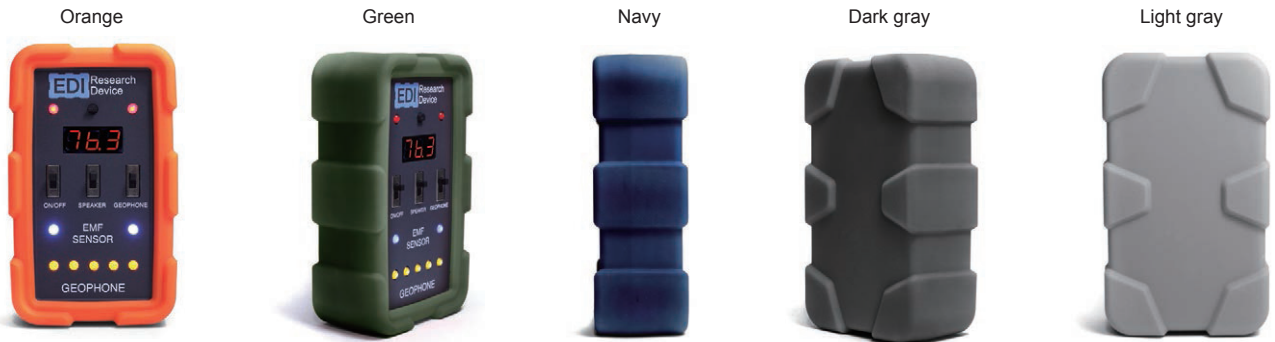

## LCS Plastic case with silicone cover



## CUSTOMIZATION



# APPLICATION EXAMPLE

## METAL COATING THICKNESS GAUGE

Product by NOVOTEST (Ukraine)



## SOLAR PANEL TROUBLE CHECKER

Product by ITES (Japan)



## SOLAR CELL DISCONNECTION CHECKER

Product by Shinei Electronic Measuring (Japan)





## DIGITAL PRESSURE GAUGE SETTER

Product by NAGANO KEIKI (Japan)



## EMF DETECTOR

Product by CenTex Paranormal (USA)



## DISTRIBUTION TRANSFORMER TESTER

Product by ndb Technologies (Canada)



## NETWORK PARTIAL DISCHARGE CHECKER

Product by ndb Technologies (Canada)



## RADIATION SURVEY METER

Product by HISAKI Sekkei (Japan)



## MINI RADIATION SURVEY METER

Product by Techno AP (Japan)



## WIRELESS VOLTAGE PROBE

Product by Enertronics (Switzerland)



## PORTABLE ANEMOMETER

Product by FieldPro (Japan)



## ULTRASONIC THICKNESS GAUGE

Product by DEMAQ (Argentina)



## HYPERHIDROSIS TREATMENT DEVICE

Product by Merebit (Czech Republic)

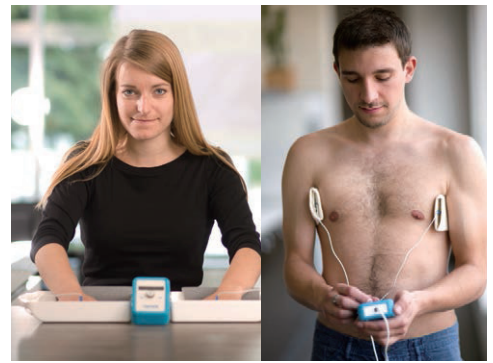

## RF SCOPE

Product by Arrow7 Corporation (Japan)



## SATELLITE BROADCASTING SIGNAL GENERATOR

Product by MASPRO (Japan)

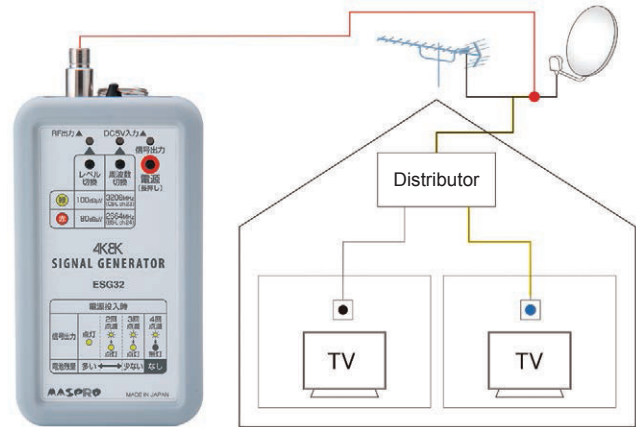

## ONBOARD PROGRAMMER

Product by Hokuto Electronic (Japan)



## CODE DEBUGGER

Product by BITRAN (Japan)





**Technical Data**

Protection class: IP40  
 Operating temperature: -10°C ~ +60°C

- Designed with beveled edges and rounded corners, and manufactured from flame-retardant ABS UL94V-0 material.
- Available in 9 different compartment types: AAx2, AAx3, AAx4, AAAx2, AAAx3, AAAx4, AAAx6, 9Vx1, and no battery compartment type.
- Positive (+) / negative (-) pole mark are incused within each battery compartment.
- Recommended to be used as measurement instruments, testing devices, wireless communication gadgets, medical equipment, and so on.

Battery compartment type

No battery compartment type

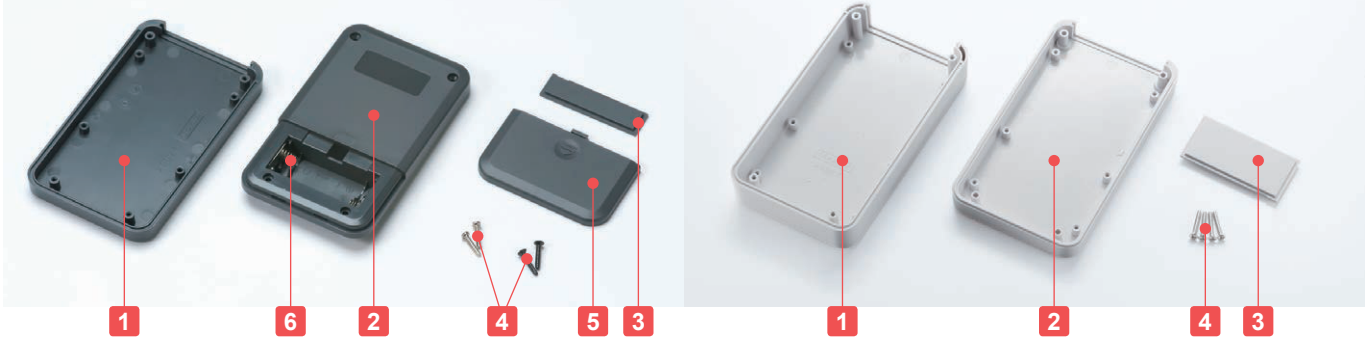

**Components**

No.	Part name	Pcs	Material	Color / Finish
1	Top cover	1	ABS UL94V-0	Off-white • Dark gray
2	Bottom cover	1	ABS UL94V-0	Off-white • Dark gray
3	Panel	1	ABS UL94V-0	Off-white • Dark gray
4	Self tapping screw	4	Steel M2.6	Nickel plated • Black trivalent chromate
5	Battery cover	1	ABS UL94V-0	Off-white • Dark gray
6	Battery contact • Battery snap	1 set	Brass • Brass : PVC	Nickel plated • Nickel plated : Black

**Accessories (Optional parts)**



Tapping standoff TPS series  
 See page TPS • MT-1



PCB mounting screw EM-2.3  
 See page EM • MR-1



TORX screw MR series  
 See page EM • MR-1



Key ring • Strap CR-20 • STP series  
 See STP • CR-1



Suspension bracket WM series  
 See page WM-1



Neodymium magnet NMG series  
 See page NMG-1



- Drawings below are reference examples only.  
DXF/DWG/PDF drawings available on our website.
- Refer to page LCT · LCS · LC · LCE-5 ~ LCT · LCS · LC · LCE-8 for detailed internal enclosure dimensions.

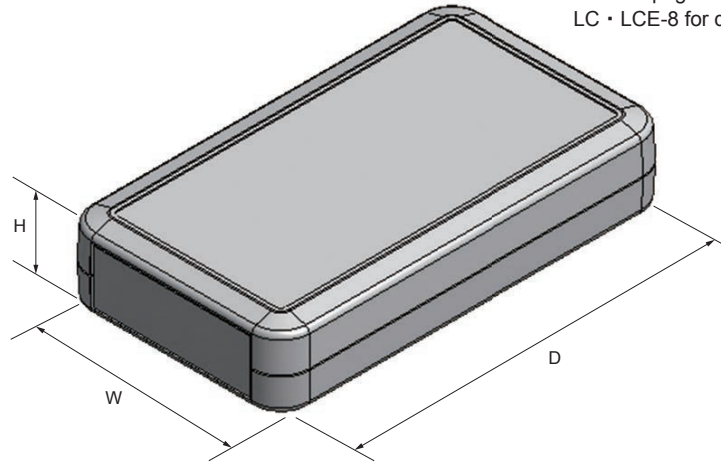

**Battery Compartment Type**

Type	N None	F2 AAx2	F3 AAx3	F4 AAx4	F6 AAx6	M2 AAx2	M3 AAx3	M4 AAx4	9V 9Vx1
Battery compartment									

**Product no. / Dimensions**

■ Please suffix color code at the end of the product number.

Product no.		W	H	D	a	b	c	d	e	f	Battery compartment	Weight (g)
● Dark gray	● Off-white											
LC115 -N -D	LC115 -N -W	69	19.5	115	54	100	48.1	12	10	9	None	70
LC115 -F2 -D	LC115 -F2 -W	69	19.5	115	54	100	48.1	12	10	9	AAA x 2	74.5
LC115 -F3 -D	LC115 -F3 -W	69	19.5	115	54	100	48.1	12	10	9	AAA x 3	76.5
LC115H -N -D	LC115H -N -W	69	28	115	54	100	48.1	20.5	18.5	9	None	80
LC115H -F2 -D	LC115H -F2 -W	69	28	115	54	100	48.1	20.5	18.5	9	AAA x 2	84.5
LC115H -F3 -D	LC115H -F3 -W	69	28	115	54	100	48.1	20.5	18.5	9	AAA x 3	86
LC115H -M2 -D	LC115H -M2 -W	69	28	115	54	100	48.1	20.5	18.5	9	AA x 2	88.5
LC115H -9V -D	LC115H -9V -W	69	28	115	54	100	48.1	20.5	18.5	9	9V x 1	88
LC135 -N -D	LC135 -N -W	76	27	135	58	117	55.1	19.5	13.5	13	None	95
LC135 -F4 -D	LC135 -F4 -W	76	27	135	58	117	55.1	19.5	13.5	13	AAA x 4	110
LC135 -M2 -D	LC135 -M2 -W	76	27	135	58	117	55.1	19.5	13.5	13	AA x 2	108
LC135 -M3 -D	LC135 -M3 -W	76	27	135	58	117	55.1	19.5	13.5	13	AA x 3	113.5
LC135 -9V -D	LC135 -9V -W	76	27	135	58	117	55.1	19.5	13.5	13	9V x 1	111.5
LC135H -N -D	LC135H -N -W	76	35	135	58	117	55.1	27.5	21.5	13	None	107.5
LC135H -F4 -D	LC135H -F4 -W	76	35	135	58	117	55.1	27.5	21.5	13	AAA x 4	122
LC135H -M2 -D	LC135H -M2 -W	76	35	135	58	117	55.1	27.5	21.5	13	AA x 2	121
LC135H -M3 -D	LC135H -M3 -W	76	35	135	58	117	55.1	27.5	21.5	13	AA x 3	126
LC135H -9V -D	LC135H -9V -W	76	35	135	58	117	55.1	27.5	21.5	13	9V x 1	123.5
LC145S -N -D	LC145S -N -W	96	20	145	75	124	71.1	12.5	7.5	12	None	110
LC145S -F6 -D	LC145S -F6 -W	96	20	145	75	124	71.1	12.5	7.5	12	AAA x 6	130
LC145 -N -D	LC145 -N -W	96	27	145	75	124	71.1	19.5	14.5	12	None	121
LC145 -F6 -D	LC145 -F6 -W	96	27	145	75	124	71.1	19.5	14.5	12	AAA x 6	141
LC145 -M2 -D	LC145 -M2 -W	96	27	145	75	124	71.1	19.5	14.5	12	AA x 2	135
LC145 -M4 -D	LC145 -M4 -W	96	27	145	75	124	71.1	19.5	14.5	12	AA x 4	142
LC145H -N -D	LC145H -N -W	96	35	145	75	124	71.1	27.5	22.5	12	None	135
LC145H -F6 -D	LC145H -F6 -W	96	35	145	75	124	71.1	27.5	22.5	12	AAA x 6	155.5
LC145H -M2 -D	LC145H -M2 -W	96	35	145	75	124	71.1	27.5	22.5	12	AA x 2	149
LC145H -M4 -D	LC145H -M4 -W	96	35	145	75	124	71.1	27.5	22.5	12	AA x 4	156
LC165 -N -D	LC165 -N -W	80	27	165	62	147	59.1	19.5	13.5	13	None	120.5
LC165 -M4 -D	LC165 -M4 -W	80	27	165	62	147	59.1	19.5	13.5	13	AA x 4	140
LC165H -N -D	LC165H -N -W	80	35	165	62	147	59.1	27.5	21.5	13	None	134.5
LC165H -M4 -D	LC165H -M4 -W	80	35	165	62	147	59.1	27.5	21.5	13	AA x 4	153.5

**LCT • LCS (Case only) / LC • LCE Dimensions**

■ Drawings below are reference examples only.  
DXF/DWG/PDF drawings available on our website.

LC / LCE / LCS / LCT115-N  
LC / LCE / LCS / LCT115H-N

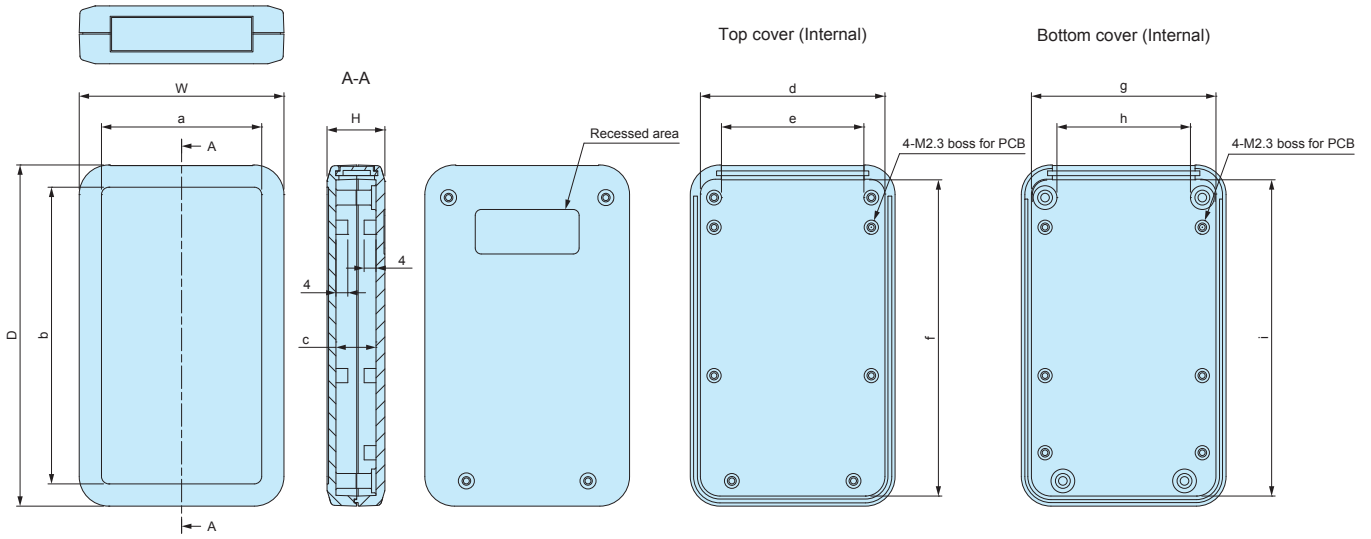

Product no.	W	H	D	a	b	c	d	e	f	g	h	i
LC • LCE • LCS • LCT115 -N	69	19.5	115	54	100	13.5	61.5	47	106.1	61.6	44	106.1
LC • LCE • LCS • LCT115H-N	69	28	115	54	100	22	60.9	47	105.5	61.5	44	106.1

LC / LCS / LCT115-F2 • LC / LCS / LCT115H-F2  
LC / LCS / LCT115-F3 • LC / LCS / LCT115H-F3  
LC / LCS / LCT115H-M2 • LC / LCS / LCT115H-9V

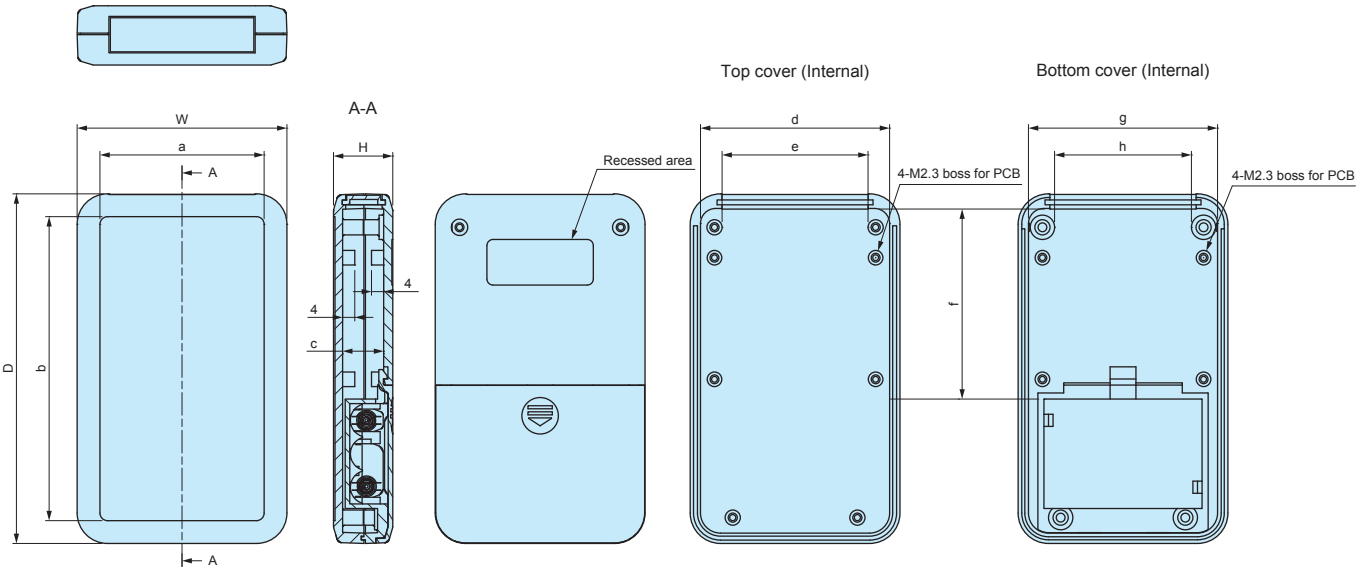

Product no.	W	H	D	a	b	c	d	e	f	g	h
LC • LCS • LCT115 -F2	69	19.5	115	54	100	13.5	61.5	47	73.3	61.6	44
LC • LCS • LCT115 -F3	69	19.5	115	54	100	13.5	61.5	47	62.3	61.6	44
LC • LCS • LCT115H-F2	69	28	115	54	100	22	60.9	47	73.3	61.6	44
LC • LCS • LCT115H-F3	69	28	115	54	100	22	60.9	47	62.3	61.6	44
LC • LCS • LCT115H-M2	69	28	115	54	100	22	60.9	47	65.1	61.6	44
LC • LCS • LCT115H-9V	69	28	115	54	100	22	60.9	47	66	61.6	44

LC / LCE / LCS / LCT135-N  
LC / LCS / LCT135H-N

※ Number of PCB bosses vary by model.  
Refer to DXF/DWG/PDF drawings for more details.

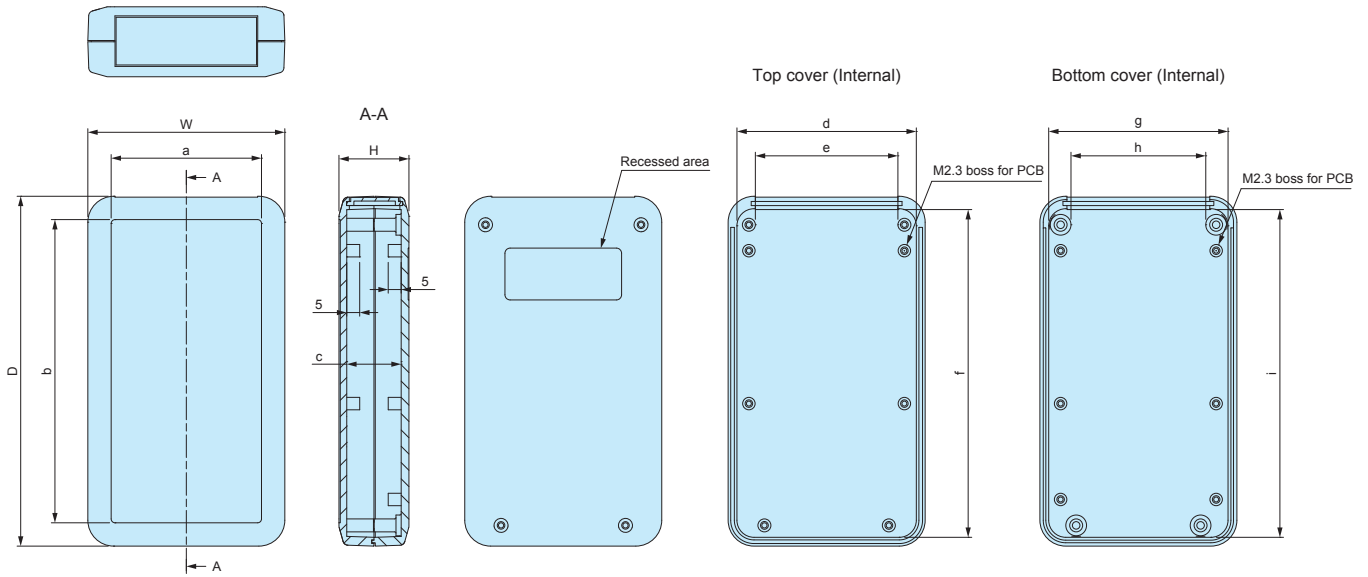

Product no.	W	H	D	a	b	c	d	e	f	g	h	i
LC • LCE • LCS • LCT135-N	76	27	135	58	117	21	68.2	55	125.8	68.3	51	125.9
LC • LCS • LCT135H-N	76	35	135	58	117	29	67.7	54	125.3	68.3	51	125.9

LC / LCS / LCT135-F4 • LC / LCS / LCT135H-F4 • LC / LCS / LCT135-M2 • LC / LCS / LCT135H-M2  
LC / LCS / LCT135-M3 • LC / LCS / LCT135H-M3 • LC / LCS / LCT135-9V • LC / LCS / LCT135H-9V

※ Number of PCB bosses vary by model.  
Refer to DXF/DWG/PDF drawings for more details.

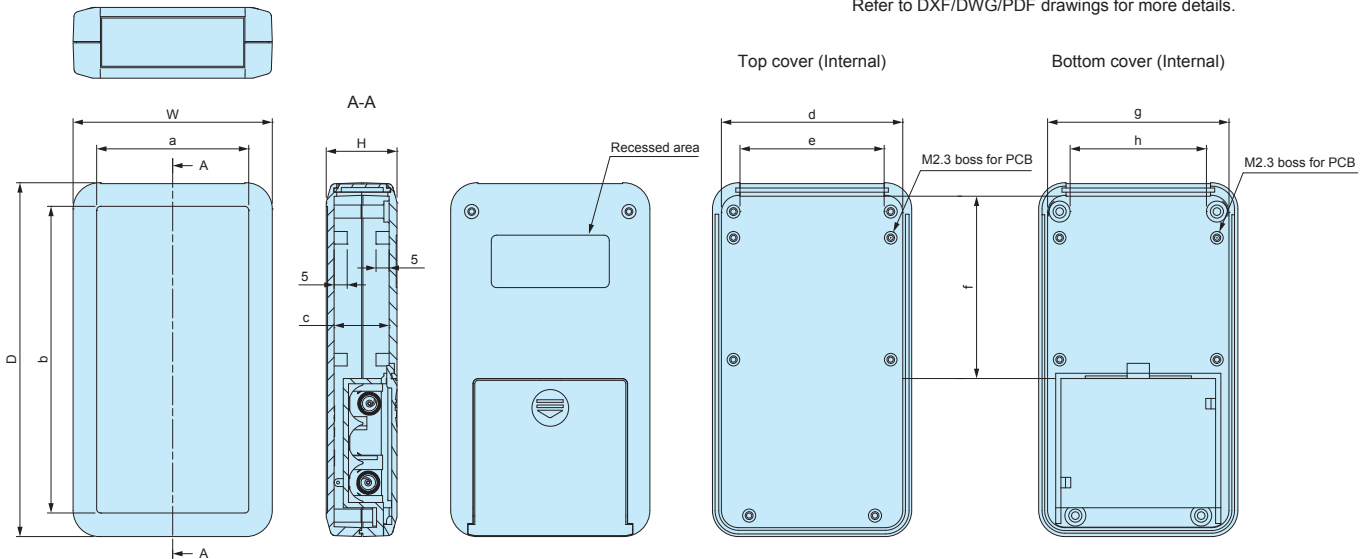

Product no.	W	H	D	a	b	c	d	e	f	g	h
LC • LCS • LCT135 -F4	76	27	135	58	117	21	68.2	55	69.4	68.3	51
LC • LCS • LCT135 -M2	76	27	135	58	117	21	68.2	55	84.5	68.3	51
LC • LCS • LCT135 -M3	76	27	135	58	117	21	68.2	55	69.4	68.3	51
LC • LCS • LCT135 -9V	76	27	135	58	117	21	68.2	55	84.5	68.3	51
LC • LCS • LCT135H-F4	76	35	135	58	117	29	67.7	54	69.4	68.3	51
LC • LCS • LCT135H-M2	76	35	135	58	117	29	67.7	54	84.5	68.3	51
LC • LCS • LCT135H-M3	76	35	135	58	117	29	67.7	54	69.4	68.3	51
LC • LCS • LCT135H-9V	76	35	135	58	117	29	67.7	54	84.5	68.3	51



**LCT • LCS (Case only) / LC • LCE Dimensions**

■ Drawings below are reference examples only.  
DXF/DWG/PDF drawings available on our website.

LC / LCS / LCT145S-N  
LC / LCS / LCT145-N  
LC / LCE / LCS / LCT145H-N

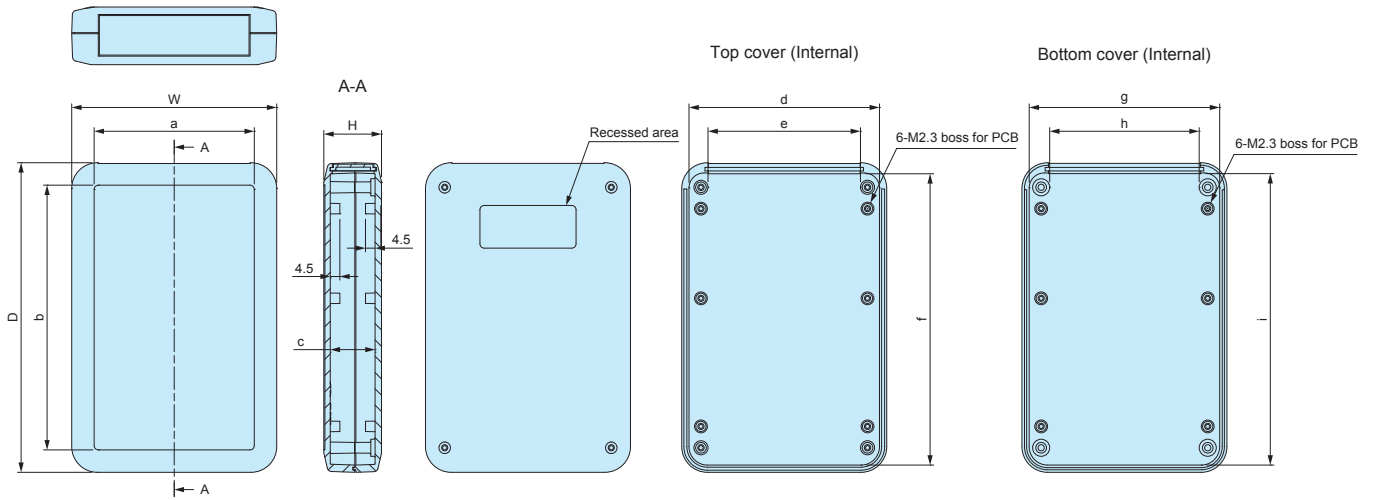

Product no.	W	H	D	a	b	c	d	e	f	g	h	i
LC • LCS • LCT145S-N	96	20	145	75	124	14	88.3	71.4	135.9	87.9	68.9	135.5
LC • LCS • LCT145 -N	96	27	145	75	124	21	87.8	71.4	135.4	87.9	68.9	135.5
LC • LCE • LCS • LCT145H-N	96	35	145	75	124	29	87.2	71	134.8	87.9	68.9	135.5

LC / LCS / LCT145S-F6 • LC / LCS / LCT145-F6 • LC / LCS / LCT145H-F6  
LC / LCS / LCT145-M2 • LC / LCS / LCT145H-M2  
LC / LCS / LCT145-M4 • LC / LCS / LCT145H-M4

※ Number of PCB bosses vary by model.  
Refer to DXF/DWG/PDF drawings for more details.

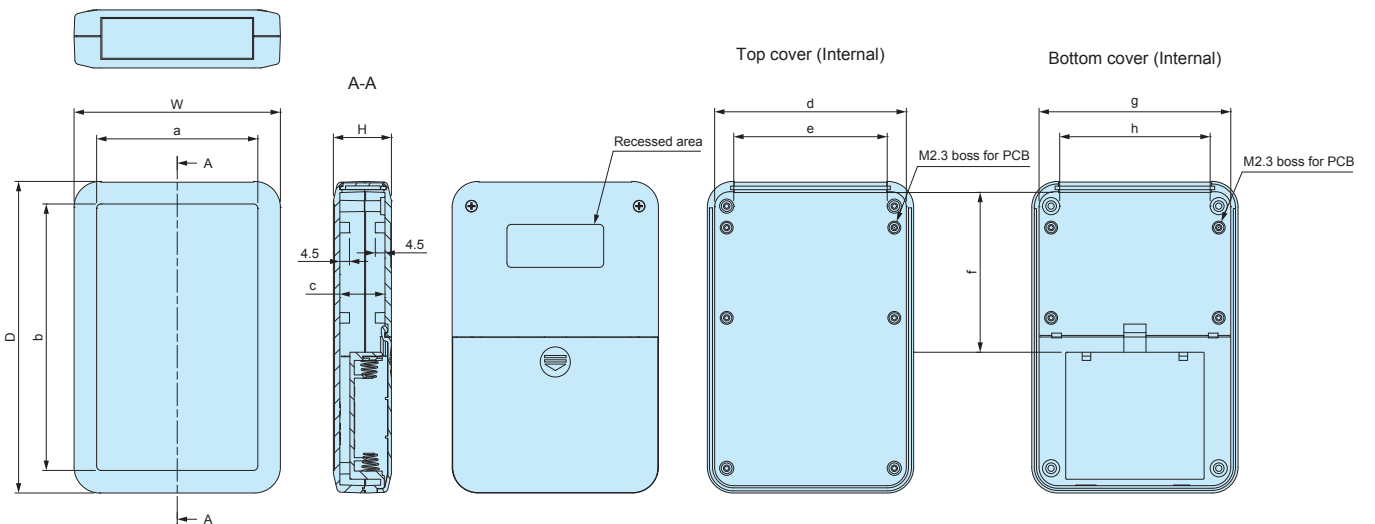

Product no.	W	H	D	a	b	c	d	e	f	g	h
LC • LCS • LCT145S -F6	96	20	145	75	124	14	88.3	71.4	78.4	87.9	68.9
LC • LCS • LCT145 -F6	96	27	145	75	124	21	87.8	71.4	78.4	87.9	68.9
LC • LCS • LCT145 -M2	96	27	145	75	124	21	87.8	71.4	97.4	87.9	68.9
LC • LCS • LCT145 -M4	96	27	145	75	124	21	87.8	71.4	74	87.9	68.9
LC • LCS • LCT145H -F6	96	35	145	75	124	29	87.2	71	78.4	87.9	68.9
LC • LCS • LCT145H-M2	96	35	145	75	124	29	87.2	71	97.4	87.9	68.9
LC • LCS • LCT145H-M4	96	35	145	75	124	29	87.2	71	74	87.9	68.9

LC / LCS / LCT165-N  
 LC / LCE / LCS / LCT165H-N

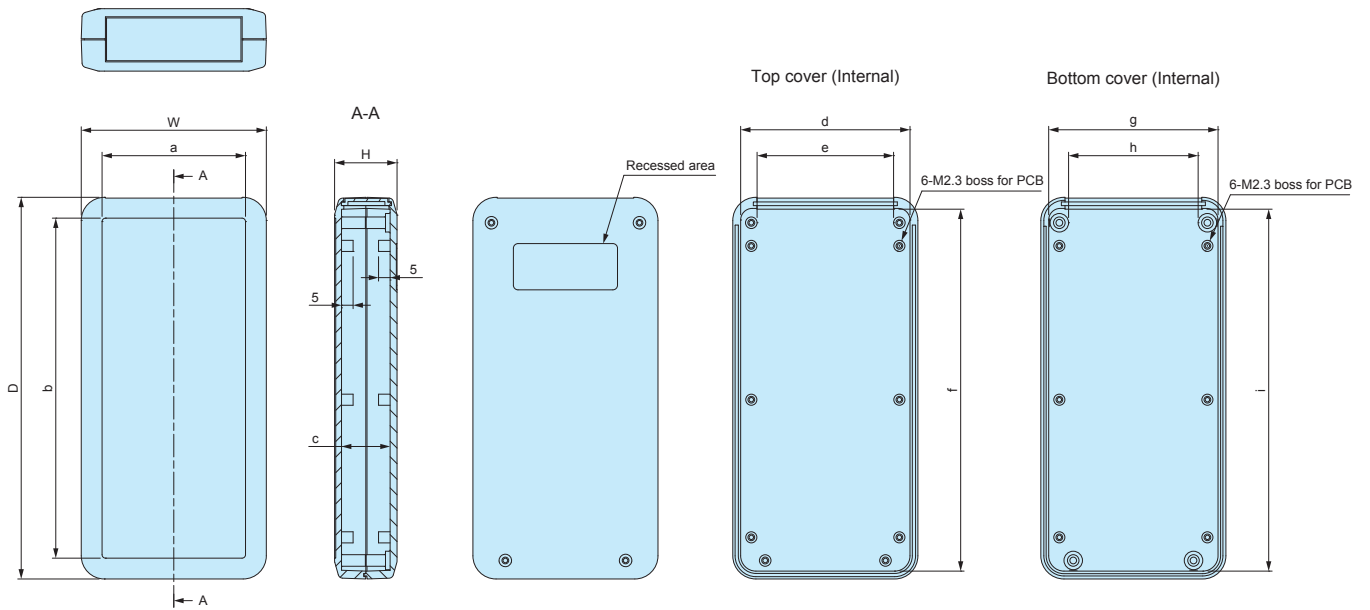

Product no.	W	H	D	a	b	c	d	e	f	g	h	i
LC • LCS • LCT165-N	80	27	165	62	147	21	72.2	58	155.8	72.3	55	155.9
LC • LCE • LCS • LCT165H-N	80	35	165	62	147	29	71.7	58	155.3	72.3	55	155.9

LC / LCS / LCT165-M4  
 LC / LCS / LCT165H-M4

※ Number of PCB bosses vary by model.  
 Refer to DXF/DWG/PDF drawings for more details.

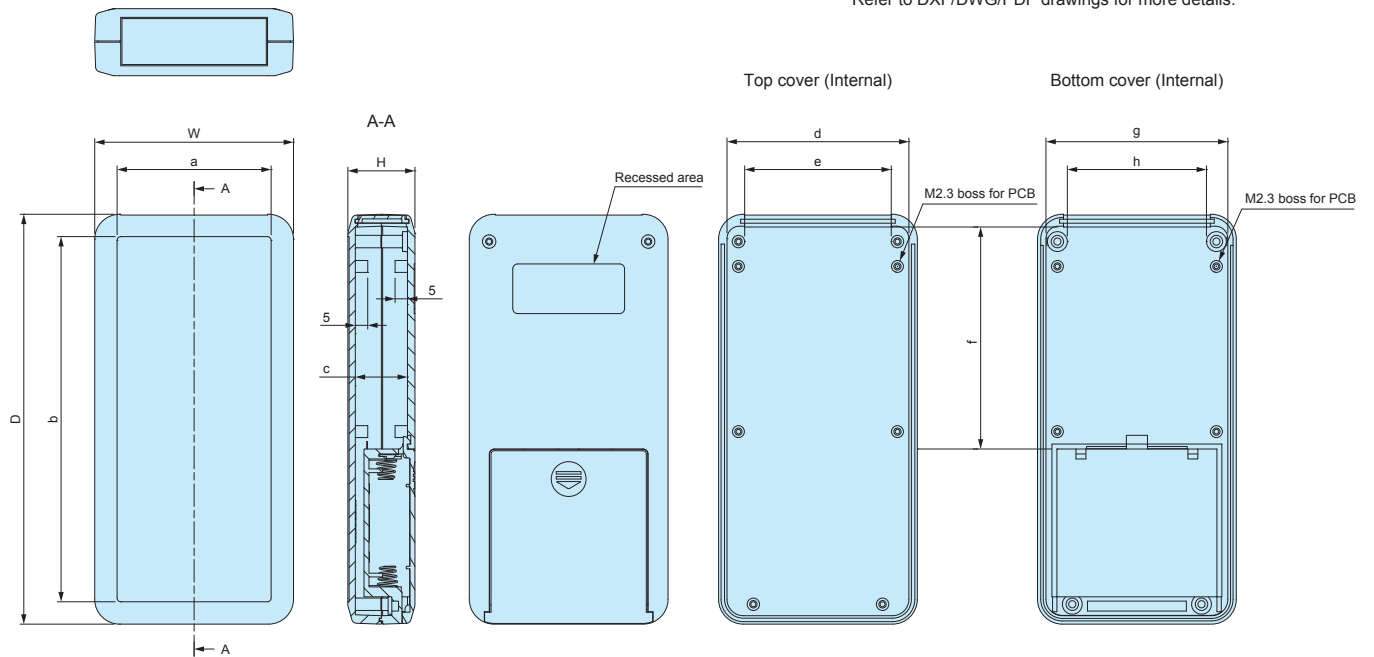

Product no.	W	H	D	a	b	c	d	e	f	g	h
LC • LCS • LCT165 -M4	80	27	165	62	147	21	72.2	58	89.2	72.3	55
LC • LCS • LCT165H-M4	80	35	165	62	147	29	71.7	58	89.2	72.3	55

# LCTP SERIES

# SHOCK-PROOF SILICONE COVER

## Color Type



- Shock-proof silicone cover for LC series. New sizes now available!
- Custom color is available from 500pcs per order batch. For custom color order, please specify **PANTONE®**, RGB color number or provide your sample color.
- Drawings below are reference examples only. DXF/DWG/PDF drawings available on our website.

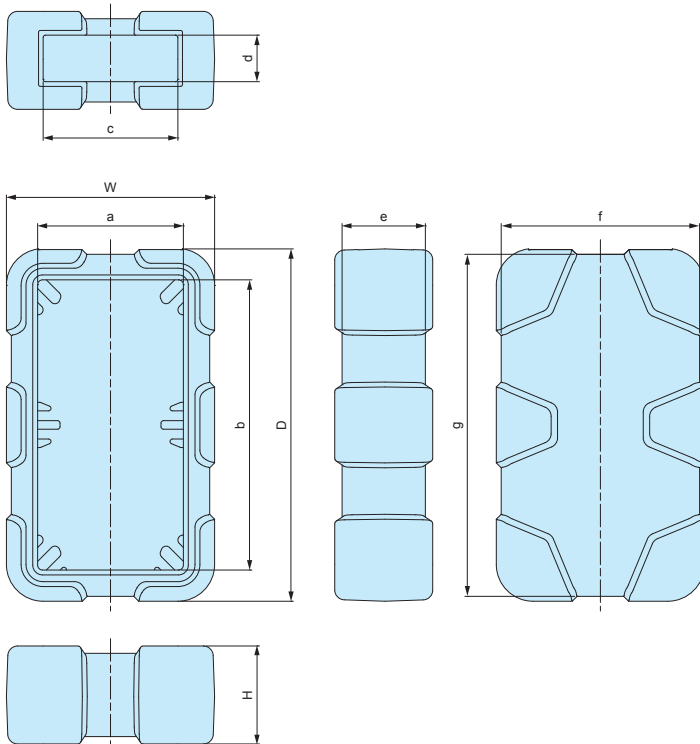

## APPLICATION EXAMPLE

**ULTRASONIC HARDNESS TESTER**  
Product by NOVOTEST (Ukraine)



## Components

Part name	Material	Color
Silicone cover	Silicone	Orange • Green • Navy • Dark gray • Light gray

## Product no. / Dimensions

■ Please suffix color code at the end of the product number.

Product no.	W	H	D	a	b	c	d	e	f	g	Suitable case	Weight (g)
LCTP115 -□	76	28	121.9	55.5	101.5	48.3	12	24	72	117.8	LC115	53.5
LCTP115H -□	76	36.5	121.9	55.5	101.5	48.3	20.5	32.5	72	117.8	LC115H	61
LCTP135 -□	85	40	143.9	59.5	118.5	55	19	34	81	139.7	LC135	115.5
LCTP135H -□	85	48	143.9	59.5	118.5	55	27	42	81	139.6	LC135H	124
LCTP145S -□	105	33	153.9	76.5	125.5	71	12	27	101	149.9	LC145S	129.1
LCTP145 -□	105	40	153.9	76.5	125.5	71	19	34	101	149.7	LC145	137.5
LCTP145H -□	105	48	153.9	76.5	125.5	71	27	42	101	149.7	LC145H	147
LCTP165 -□	89	40	173.9	63.5	148.5	59	19	34	85	169.7	LC165	143
LCTP165H -□	89	48	173.9	63.5	148.5	59	27	42	85	169.6	LC165H	151.5



# LCSC SERIES

# SILICONE COVER

### Color Type



- Silicone cover for LC Series.
- Custom color is available from 500pcs per order batch. For custom color order, please specify **PANTONE®**, RGB color number or provide your sample color.
- Drawings below are reference examples only. DXF/DWG/PDF drawings available on our website.

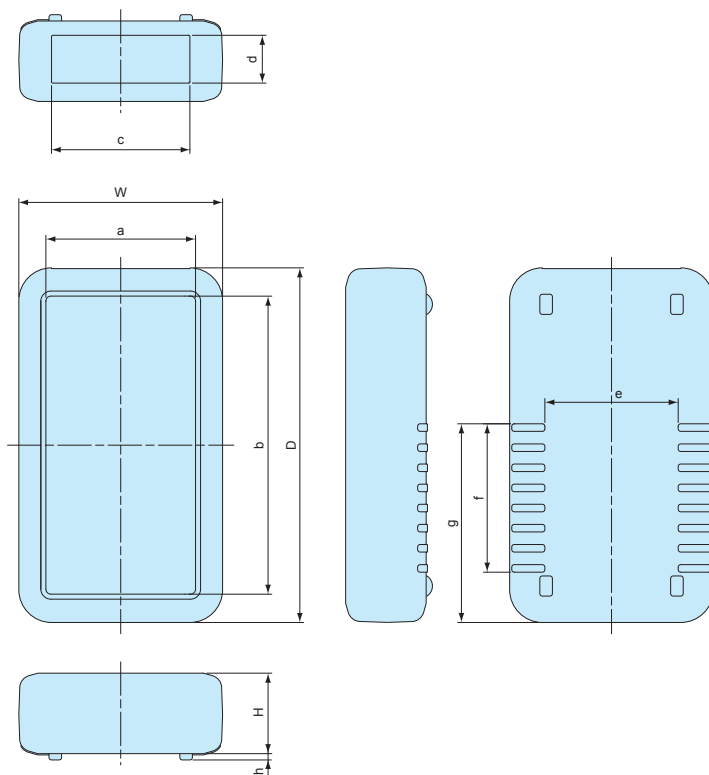

### APPLICATION EXAMPLE

#### TEMPERATURE SURVEILLANCE SENSOR

Product by SENFIO (Brazil)



### Components

Part name	Material	Color
Silicone cover	Silicone	Red • Yellow • Green • Blue • Navy • Dark gray • Light gray

### Product no. / Dimensions

■ Please suffix color code at the end of the product number.

Product no.	W	H	D	a	b	c	d	e	f	g	h	Suitable case	Weight (g)
LCSC115 -□	74	24	120	55.5	101.5	48.3	12	46	44.5	60.5	2	LC115	43
LCSC115H-□	74	32.5	120	55.5	101.5	48.3	20.5	46	44.5	60.5	2	LC115H	50
LCSC135 -□	81	32	141	59.5	118.5	55	19	53	59	79	2.5	LC135	70
LCSC135H-□	81	40	141	59.5	118.5	55	27	53	59	79	2.5	LC135H	75.5
LCSC145S-□	101	25	151	76.5	125.5	71	12	71	59	81	2.5	LC145S	73.4
LCSC145 -□	101	32	151	76.5	125.5	71	19	71	59	81	2.5	LC145	81
LCSC145H-□	101	40	151	76.5	125.5	71	27	71	59	81	2.5	LC145H	89
LCSC165 -□	85	32	171	63.5	148.5	59	19	53	67	92	2.5	LC165	82.5
LCSC165H-□	85	40	171	63.5	148.5	59	27	53	67	92	2.5	LC165H	86

TPS SERIES

TAPPING STANDOFF



- Tapping screw head allows for easy installation onto existing enclosure boss mount.
- 3 different sizes available : M2.3, M2.6 and M3 size.

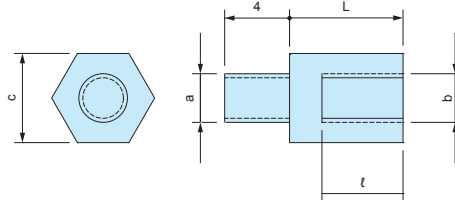

Product no. / Dimensions

■ Material / Finish : Brass / Unfinished

Product no.	Screw size (a)	Screw size (b)	c	L	ℓ	Pack of	Recommended enclosure models	
TPS-M2.3-4	M2.3	M2.3	5	4	3	4	WH series • PFE series LC • LCE • LCS • LCT series PF • PFF series (M2.3 boss models) TW • TWN • TWF series (M2.3 boss models) WP series (M2.3 boss models)	
TPS-M2.3-5	M2.3	M2.3	5	5	3	4		
TPS-M2.3-6	M2.3	M2.3	5	6	4	4		
TPS-M2.3-7	M2.3	M2.3	5	7	5	4		
TPS-M2.3-8	M2.3	M2.3	5	8	6	4		
TPS-M2.3-10	M2.3	M2.3	5	10	6	4		
TPS-M2.3-12	M2.3	M2.3	5	12	6	4		
TPS-M2.6-4	M2.6	M2.6	5	4	3	4		PF • PFF series (M2.6 boss models) WP series (M2.6 boss models)
TPS-M2.6-5	M2.6	M2.6	5	5	3	4		
TPS-M2.6-7	M2.6	M2.6	5	7	5	4		
TPS-M2.6-10	M2.6	M2.6	5	10	6	4		
TPS-M2.6-12	M2.6	M2.6	5	12	6	4	SU • OP series TWS • TW • TWN • TWF series (M3 boss models)	
TPS-M3-4	M3	M3	5.5	4	3	4		
TPS-M3-5	M3	M3	5.5	5	3	4		
TPS-M3-6	M3	M3	5.5	6	4	4		
TPS-M3-7	M3	M3	5.5	7	5	4		
TPS-M3-8	M3	M3	5.5	8	5	4		
TPS-M3-10	M3	M3	5.5	10	6	4		
TPS-M3-12	M3	M3	5.5	12	6	4		



- Please use a suitable sized socket driver to both secure and loosen the tapping standoff.



MT SERIES

PCB MOUNTING SCREWS for TPS



- PCB mounting Screws for TPS tapping standoffs.

Product no. / Dimensions

Product no.	M	L	Head style	Material	Finish	Pack of
<b>NEW</b> MT2.3-4	2.3	4	Pan	Steel	Trivalent chromate	20
<b>NEW</b> MT2.3-6	2.3	6		Steel	Trivalent chromate	20
<b>NEW</b> MT2.6-4	2.6	4		Steel	Trivalent chromate	20
MT3-4	3	4		Steel	Trivalent chromate	20

EM SERIES

PCB MOUNTING SCREW

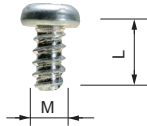

- Self-tapping screws for mounting PCB on bosses or standoffs.
- EM-3-6 self-tapping screws are suitable for mounting 1.6mm or thicker PCB.

Product no. / Dimensions

Product no.	M	L	Material	Finish	Suitable enclosures	Pack of
EM-1.6	1.6	4	Steel	Trivalent chromate	WC • CSS • CS • PS (M1.6 size)	50
EM-2	2	5	Steel	Trivalent chromate	PS • TW • TWN • TWF • WP (M2 size)	50
EM-2.3	2.3	6	Steel	Trivalent chromate	WH • LC • LCT • LCS • LCE • PFE WSC (Top cover bosses) PF • PFF (M2.3 size) TW • TWN • TWF (M2.3 size) WP (M2.3 size)	50
<b>NEW</b> EM-2.3-8	2.3	8	Steel	Trivalent chromate	WSC (Bottom base bosses)	50
EM-2.6	2.6	6	Steel	Trivalent chromate	PF • PFF • WP (M2.6 size)	50
EM-3	3	5	Steel	Trivalent chromate	SU TWS • TW • TWN • TWF (M3 sizes)	50
EM-3-6	3	6	Steel	Trivalent chromate		50

MR SERIES

TORX SCREW



Countersunk head

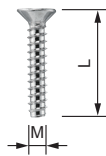

Pan head

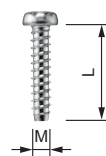

With pin



★ Without pin

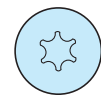

★ : MR1.6-6S, MR-2S, MR2.6-10□, and MR3-14□ are without pin.

Product no. / Dimensions

★Mark = Without pin

Product no.	M	L	head no.	Head style	Material	Finish	Suitable enclosures	Pack of
MR1.6-6S★	1.6	6	T3	Pan	Steel	Nickel plated	CS • CSS	20
MR2.5-8PS	2.5	8	T8	Pan	Steel	Nickel plated	PF • PFE • PFF (M2.5 size)	20
MR2.6-10S★	2.6	10	T8	Countersunk	Steel	Nickel plated	TW • TWN (M2.6 models) TWF (M2.6 models)	20
MR2.6-10B★	2.6	10	T8	Countersunk	Steel	Black trivalent chromate	MX • MXA • MXB • MXF (M2.6 models)	20
MR2.6-12PS	2.6	12	T8	Pan	Steel	Nickel plated	LCT • LCS • LC115-F2 / F3 LCT • LCS • LC145S-F6	20
MR2.6-14PS	2.6	14	T8	Pan	Steel	Nickel plated	LCT • LCS • LC115H-F2 / F3 / M2 / 9V LCT • LCS • LC135-F4 / M2 / M3 / 9V LCT • LCS • LC135H-F4 / M2 / M3 / 9V LCT • LCS • LC145-F6 / M2 / M4 LCT • LCS • LC145H-F6 / M2 / M4 LCT • LCS • LC165-M4 LCT • LCS • LC165H-M4	20
MR2.6-14S	2.6	14	T8	Countersunk	Steel	Nickel plated	LCT • LCS • LC115-N / F2 / F3 LCT • LCS • LC145S-F6 / 145S-N LCE115-N TW • TWN7-2-11 / 7-4-11 / 7-5-11 TWF7-2-11 / 7-4-11 / 7-5-11 / 8-2-8 / 8-4-8	20
MR2.6-18S	2.6	18	T8	Countersunk	Steel	Nickel plated	LCT • LCS • LC115H-N / F2 / F3 / M2 / 9V LCT • LCS • LC135-N / F4 / M2 / M3 / 9V LCT • LCS • LC135H-N / F4 / M2 / M3 / 9V LCT • LCS • LC145-N / F6 / M2 / M4 LCT • LCS • LC145H-N / F6 / M2 / M4 LCT • LCS • LC165-N / M4 LCT • LCS • LC165H-N / M4 LCE115H-N • LCE135-N • LCE145H-N • LCE165H-N	20
MR3-8PS	3	8	T10	Pan	Steel	Nickel plated	PF • PFE • PFF (M3 size)	20
MR3-14S★	3	14	T10	Countersunk	Steel	Nickel plated	TW • TWN (M3 models)	20
MR3-14B★	3	14	T10	Countersunk	Steel	Black trivalent chromate	TWF (M3 models) MX • MXA • MXB • MXF (M3 models)	20
MR-1S	3	5	T10	Countersunk	Steel	Nickel plated	UC	20
MR-1B	3	5	T10	Countersunk	Steel	Black trivalent chromate	UC • UCY • US	20
MR-2S	3	10	T10	Countersunk	Steel	Nickel plated	HEN	20



STP SERIES

STRAP

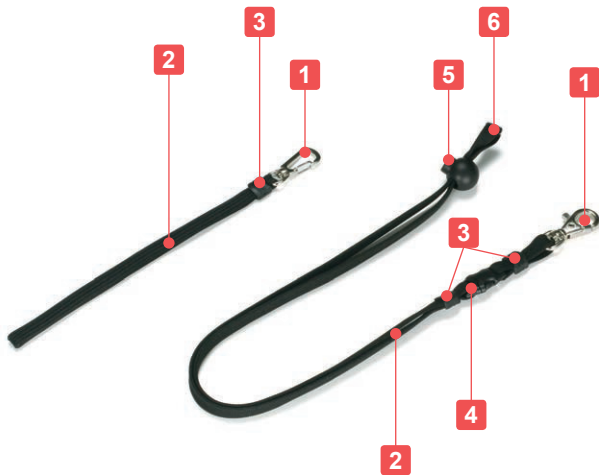

Wrist strap (STP-200)

Neck strap (STP-450)



- Strap with a metal hook
- Recommended to be used with CR key ring.

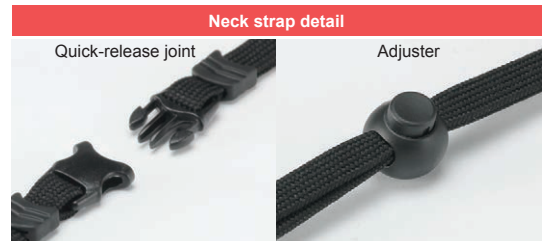

■ Only the neck strap has a joint and an adjuster.

Components

No.	Part name	Pcs	Material	Color / Finish
1	Metal hook	1	Diecast zinc & steel	Nickel plated
2	Strap	1	Nylon / Polyester	Black
3	Cap	1 / 2	Polyurethane / Elastomer	Black
4	Joint (Neck strap only)	1	Polyacetal	Black
5	Adjuster (Neck strap only)	1	Nylon	Black
6	Clamp (Neck strap only)	1	PE	Black

Product no. / Dimensions

Product no.	Strap width	Strap length	Strap material	Cap material
STP-200	8	200	Nylon	Polyurethane x 1
STP-450	10	450	Polyester	Elastomer x 2

CR-20

KEY RING

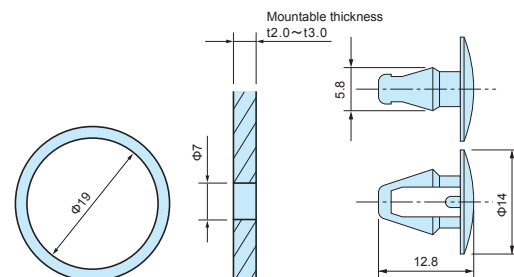

Components

Part name	Material	Color / Finish
Ring	SWRM 6 Steel	Nickel plated
Insert clip	Nylon	Black

- Hole milling is required for case installation.

Product no. / Dimensions

Product no.	Ring Φ	Installation hole	Mounting thickness
CR-20	φ19	φ7	t2.0 ~ t3.0

WM SERIES

SUSPENSION BRACKET

How to install

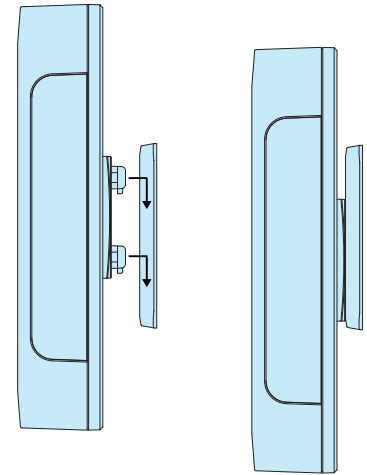

- Plastic wall mounting bracket. Easy attachment and removal.
  - Large and small brackets are available.
  - Applicable not only for the PF series, but also other plastic/metal enclosures with a panel thickness of 0.8 ~ 3.5mm.
  - To attach the suspension hook onto the enclosure, hole milling is required.
- 
- The max load values listed are static load values only. Use caution when handling.
  - Please be aware of the insertion direction of the suspension hook against the mounting base when attaching.

Technical Data	
Max load : 2 kg - WM-1	5 kg - WM-2

WM-1

WM-2

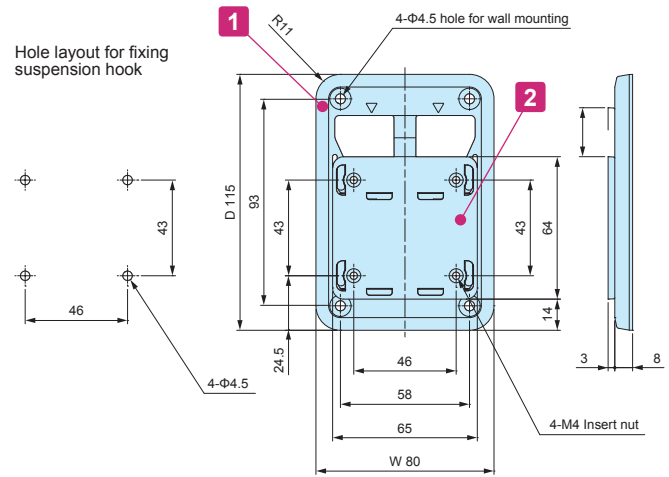
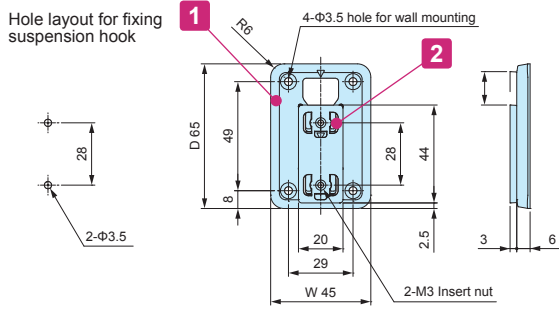

■ DXF/DWG/PDF drawings available on our website.

Components

No.	Part name	Pcs	Material	Color / Finish
1	Mounting base	1	PC + ABS UL94HB	Off-white • Dark gray
2	Suspension hook	1	PC + ABS UL94HB	Off-white • Dark gray
-	Insert nut	2 / 4	Brass	Unfinished
-	Screw	2	M3-8 Steel binding = WM-1	Nickel plated
-	Screw	4	M4-8 Steel binding = WM-2	Nickel plated

Product no. / Dimensions

Product no.		Dimensions		Mountable thickness	Weight (g)
● Off-white	● Dark gray	W	D		
WM-1W	WM-1D	45	65	t0.8 ~ t3.5	11.5
WM-2W	WM-2D	80	115	t0.8 ~ t3.5	48

NMG SERIES

NEODYMIUM MAGNET



Round magnet



- Material / Finish: Neodymium / Nickel plated
- Please attach using a strong adhesive.

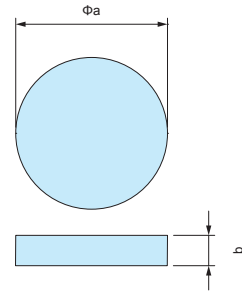

Components

Product no.	a	b	Weight (g)	Flus Density	Adsorption
NMG3-15N	15	3	4	214.4 mT	2.44 kgf
NMG3-20N	20	3	7.1	170.7 mT	3.26 kgf
NMG5-22N	22	5	11.4	247.2 mT	5.91 kgf
NMG5-25N	25	5	18.4	221.9 mT	6.89 kgf

Round magnet with countersunk hole



- Please fasten with a screw.

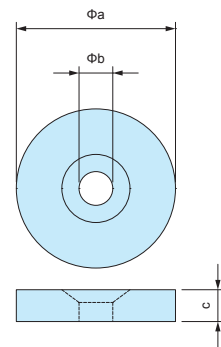

Components

Product no.	a	b	c	Countersunk size	Weight (g)	Flus Density	Adsorption
NMG3-15M3	15	3.2	3	M3	3.8	214.3 mT	2.33 kgf
NMG3-20M3	20	3.2	3	M3	6.9	170.6 mT	3.17 kgf
NMG5-22M4	22	4.3	5	M4	13.7	247.2 mT	5.68 kgf
NMG5-25M5	25	5.3	5	M5	17.6	221.9 mT	6.58 kgf

Rectangular magnet with countersunk holes



- Please fasten with a screw.

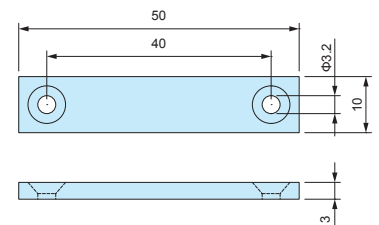

Components

Product no.	a	b	c	Countersunk size	Weight (g)	Flus Density	Adsorption
NMG3-50M3	50	10	3	M3	11.3	210.0 mT	9.1 kgf

Example 1 The magnetic force remains strong even through plastic.

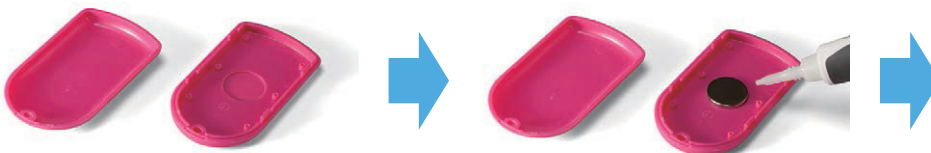

Make recessed pocket on the inside wall.

Glue on.



Attach onto a metallic surface.

Example 2

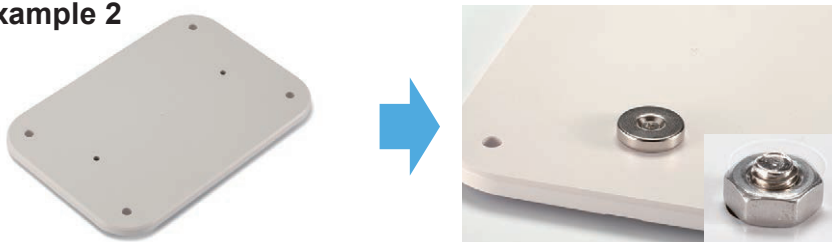

Make holes

Fasten with a screw and nut.



Attach onto a metallic surface.

**CAUTION: Handle with care to avoid personal injury or damage to the magnet.**