

HSTP SERIES

SHOULDER STRAP



Product no. / Feature

Product no.	Weight (g)	Quantity
HSTP1000	129	1

- Hole milling is required on the case for shoulder strap installation.
- Recommended hole for installation is $\phi 6.2\text{mm}$.

ML SERIES

COLOR LATCH for MAXI

- Replacement latch for MAXI case.



How to remove latch

Hold the case and pull the latch.



How to install latch

Hold the case, insert thinner side first, and push the opposite side in.

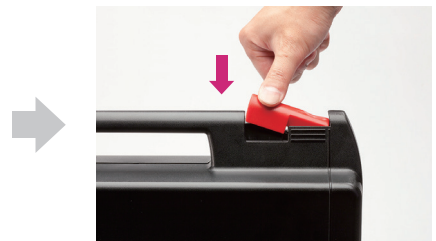
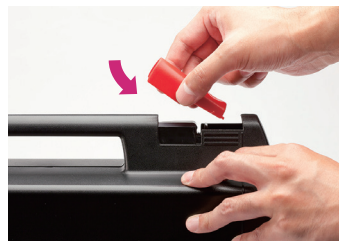

Product no. / Suitable case

Product no.							Suitable case	Quantity
● Black	● Marine	● Yellow	● Orange	● Red	● Light gray	● Gray		
ML-SB	ML-SM	ML-SY	ML-SO	ML-SR	ML-SL	ML-SG	MAXI 252307 B ~ MAXI 292614 B	2
ML-LB	ML-LM	ML-LY	ML-LO	ML-LR	ML-LL	ML-LG	MAXI 353106 B ~ MAXI 544521 B	2