

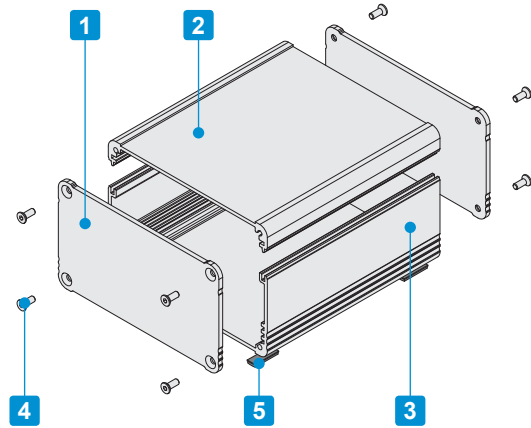

- Simple yet beautifully designed aluminium extrusion enclosure.
- Selectable in 4 different color combinations.
- Beautiful high-end finish is achieved by precision CNC finishing.
- Suitable for industrial and audio interface equipment.
- Custom length is available.



Components

No.	Part name	Pcs	Material	Color / Finish
1	End panel	2	Aluminium A1050P	Silver • Black / Anodized
2	Top cover	1	Extruded aluminium A6063S-T5	Silver • Black / Anodized
3	Bottom cover	1	Extruded aluminium A6063S-T5	Silver • Black / Anodized
4	Screw	8	Stainless steel	Unfinished
5	Rubber feet	4	Polyurethane	Black

■ See page 149 ~ 152 for Top / Bottom cover dimensions.

Color Type

Code	S S Silver / Silver	S B Silver / Black	B S Black / Silver	B B Black / Black
Color				

■ Drawings below are reference examples only.
DXF/DWG/PDF drawings available on our website.

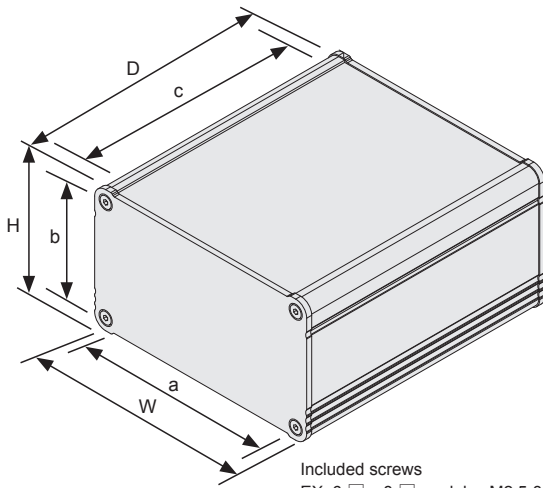

Included screws
EX 6-□, 8-□ models : M2.5-8 x 8 pcs
EX11-□, 14-□ models : M3-8 x 8 pcs
EX19-□ models : M4-10 x 8 pcs
EX23-□ models : M5-10 x 8 pcs
※Hexagonal wrench included.

Accessories (Optional parts)



Wall mounting bracket EF series
See page 182

Product no. / Dimensions

■ Please suffix color code at the end of the product number.

Product no.	Dimensions (External)			Dimensions (Internal)		
	W	H	D	a	b	c
EX 6- 3- 5□□	60.6	25.6	50	47	19.6	46
EX 6- 3- 8□□	60.6	25.6	77	47	19.6	73
EX 6- 3-10□□	60.6	25.6	100	47	19.6	96
EX 6- 4- 5□□	60.6	35.6	50	47	29.6	46
EX 6- 4- 8□□	60.6	35.6	77	47	29.6	73
EX 6- 4-10□□	60.6	35.6	100	47	29.6	96
EX 6- 5- 5□□	60.6	50.6	50	47	44.6	46
EX 6- 5- 8□□	60.6	50.6	77	47	44.6	73
EX 6- 5-10□□	60.6	50.6	100	47	44.6	96
EX 8- 3- 6□□	80.6	30.6	60	67	24.6	56
EX 8- 3- 9□□	80.6	30.6	90	67	24.6	86
EX 8- 3-12□□	80.6	30.6	120	67	24.6	116
EX 8- 4- 6□□	80.6	40.6	60	67	34.6	56
EX 8- 4- 9□□	80.6	40.6	90	67	34.6	86
EX 8- 4-12□□	80.6	40.6	120	67	34.6	116
EX 8- 6- 6□□	80.6	55.6	60	67	49.6	56
EX 8- 6- 9□□	80.6	55.6	90	67	49.6	86
EX 8- 6-12□□	80.6	55.6	120	67	49.6	116
EX11- 3- 8□□	106	31	79	89	24	74
EX11- 3-12□□	106	31	119	89	24	114
EX11- 3-16□□	106	31	165	89	24	160
EX11- 5- 8□□	106	46	79	89	39	74
EX11- 5-12□□	106	46	119	89	39	114
EX11- 5-16□□	106	46	165	89	39	160
EX11- 6- 8□□	106	61	79	89	54	74
EX11- 6-12□□	106	61	119	89	54	114
EX11- 6-16□□	106	61	165	89	54	160
EX14- 4-10□□	141	36	98	107.4	29	93
EX14- 4-14□□	141	36	138	107.4	29	133
EX14- 4-19□□	141	36	188	107.4	29	183
EX14- 5-10□□	141	51	98	107.4	44	93
EX14- 5-14□□	141	51	138	107.4	44	133
EX14- 5-19□□	141	51	188	107.4	44	183
EX14- 7-10□□	141	71	98	107.4	64	93
EX14- 7-14□□	141	71	138	107.4	64	133
EX14- 7-19□□	141	71	188	107.4	64	183
EX14- 9-10□□	141	91	98	107.4	84	93
EX14- 9-14□□	141	91	138	107.4	84	133
EX14- 9-19□□	141	91	188	107.4	84	183

Product no.	Dimensions (External)			Dimensions (Internal)		
	W	H	D	a	b	c
NEW EX19- 4-13□□	186.5	43.5	125	132	35	120
NEW EX19- 4-18□□	186.5	43.5	177	132	35	172
NEW EX19- 4-23□□	186.5	43.5	230	132	35	225
NEW EX19- 4-29□□	186.5	43.5	285	132	35	280
NEW EX19- 6-13□□	186.5	61.5	125	132	53	120
NEW EX19- 6-18□□	186.5	61.5	177	132	53	172
NEW EX19- 6-23□□	186.5	61.5	230	132	53	225
NEW EX19- 6-29□□	186.5	61.5	285	132	53	280
NEW EX19- 8-13□□	186.5	81.5	125	132	73	120
NEW EX19- 8-18□□	186.5	81.5	177	132	73	172
NEW EX19- 8-23□□	186.5	81.5	230	132	73	225
NEW EX19- 8-29□□	186.5	81.5	285	132	73	280
NEW EX19-11-13□□	186.5	106.5	125	132	98	120
NEW EX19-11-18□□	186.5	106.5	177	132	98	172
NEW EX19-11-23□□	186.5	106.5	230	132	98	225
NEW EX19-11-29□□	186.5	106.5	285	132	98	280
NEW EX23- 5-15□□	232	52	153	177	43	147
NEW EX23- 5-21□□	232	52	213	177	43	207
NEW EX23- 5-27□□	232	52	273	177	43	267
NEW EX23- 5-33□□	232	52	333	177	43	327
NEW EX23- 8-15□□	232	77	153	177	68	147
NEW EX23- 8-21□□	232	77	213	177	68	207
NEW EX23- 8-27□□	232	77	273	177	68	267
NEW EX23- 8-33□□	232	77	333	177	68	327
NEW EX23-10-15□□	232	102	153	177	93	147
NEW EX23-10-21□□	232	102	213	177	93	207
NEW EX23-10-27□□	232	102	273	177	93	267
NEW EX23-10-33□□	232	102	333	177	93	327

EXP • EXPE • EXW • EXPF • EXEF • EXWF • EX top / bottom covers

■ Drawings below are reference examples only.
DXF/DWG/PDF drawings available on our website.

EXP • EXPE • EXW • EXPF • EXEF • EXWF7-4-□
EX6-3-□

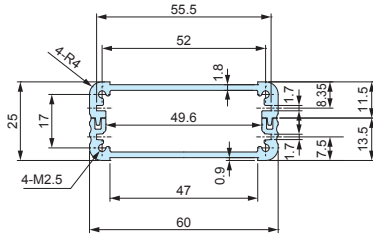

EXP • EXPE • EXW • EXPF • EXEF • EXWF7-4-□
EX6-4-□

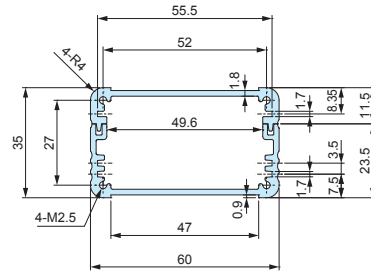

EXP • EXPE • EXW • EXPF • EXEF • EXWF7-6-□
EX6-5-□

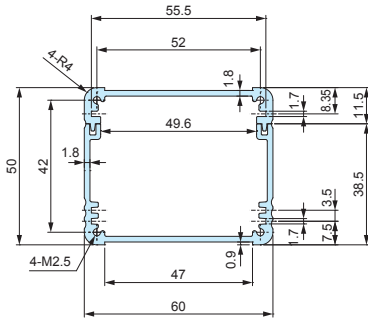

EXP • EXPE • EXW • EXPF • EXEF • EXWF9-4-□
EX8-3-□

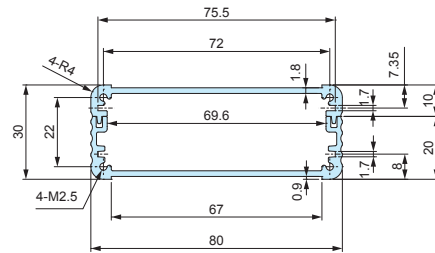

EXP • EXPE • EXW • EXPF • EXEF • EXWF9-5-□
EX8-4-□

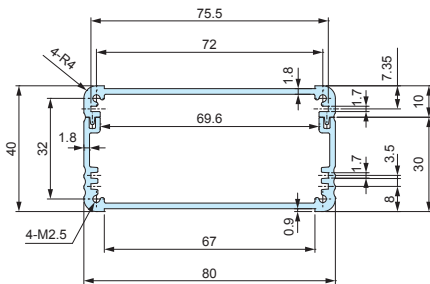

EXP • EXPE • EXW • EXPF • EXEF • EXWF9-6-□
EX8-6-□

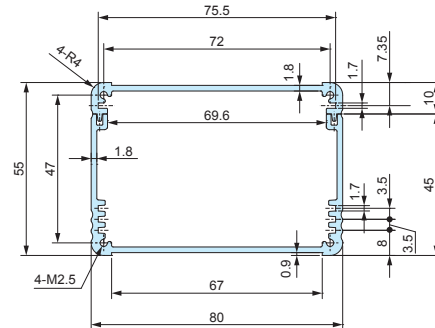

EXP • EXPE • EXW12-4-□
EXPF • EXEF • EXWF11-4-□
EX11-3-□

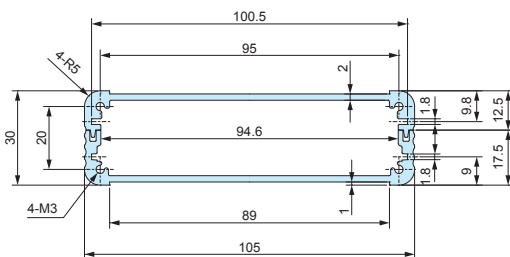

EXP • EXPE • EXW12-6-□
EXPF • EXEF • EXWF11-6-□
EX11-5-□

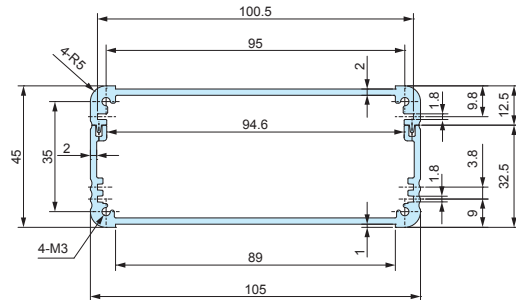

EXP • EXPE • EXW • EXPF • EXEF • EXWF • EX top / bottom covers

■ Drawings below are reference examples only.
DXF/DWG/PDF drawings available on our website.

EXP • EXPE • EXW12-7-□
EXPF • EXEF • EXWF11-7-□
EX11-6-□

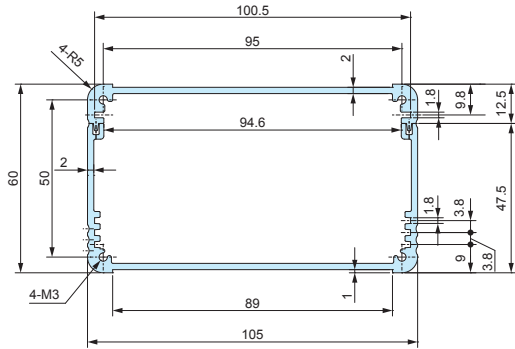

EXP • EXPE • EXW • EXPF • EXEF • EXWF15-5-□
EX14-4-□

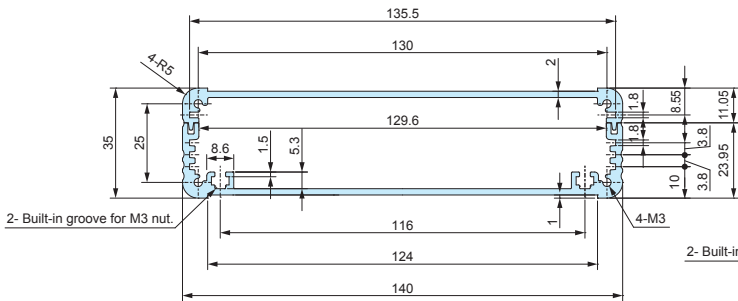

EXP • EXPE • EXW • EXPF • EXEF • EXWF15-6-□
EX14-5-□

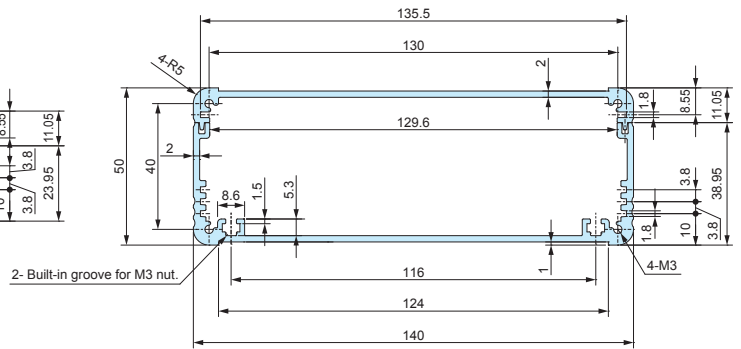

EXP • EXPE • EXW • EXPF • EXEF • EXWF15-8-□
EX14-7-□

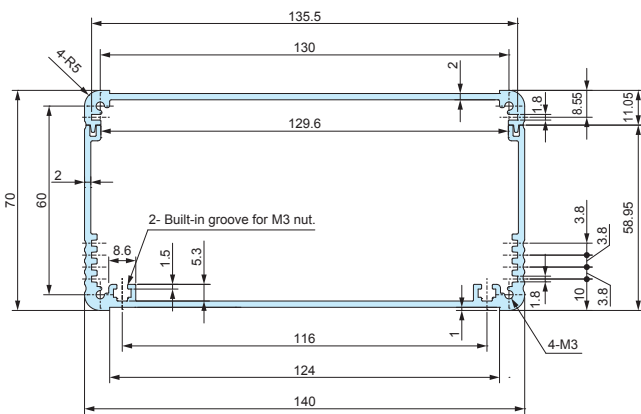

EXP • EXPE • EXW • EXPF • EXEF • EXWF15-10-□
EX14-9-□

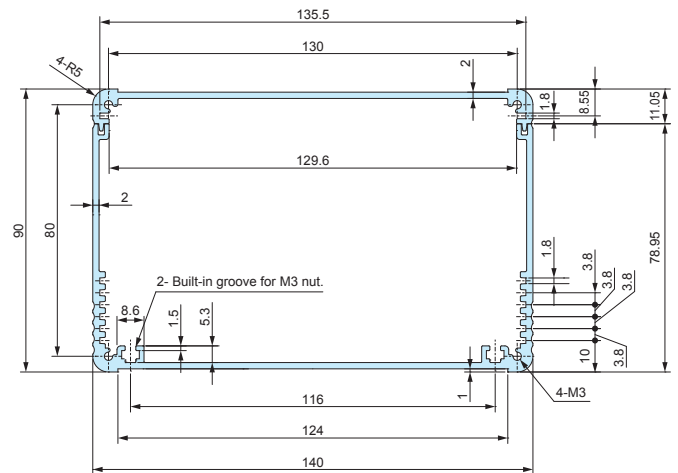

EXP • EXPE • EXPF • EXEF • EXWF • EX top / bottom covers

■ Drawings below are reference examples only.
DXF/DWG/PDF drawings available on our website.

EXP • EXPE • EXPF • EXEF • EXWF20-6-□
EX19-4-□

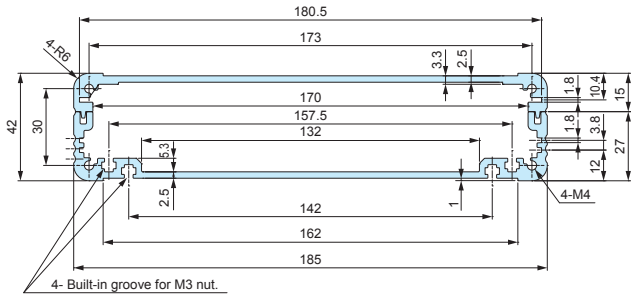

EXP • EXPE20-7-□
EXPF • EXEF • EXWF20-8-□
EX19-6-□

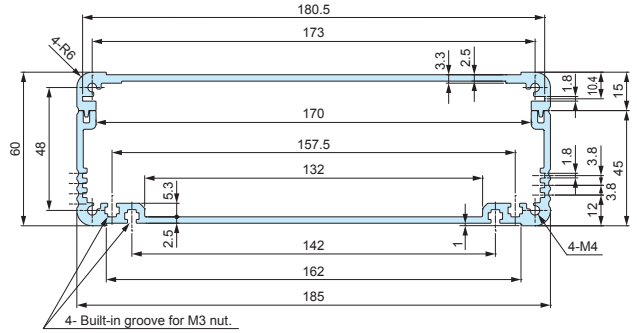

EXP • EXPE20-9-□
EXPF • EXEF • EXWF20-10-□
EX19-8-□

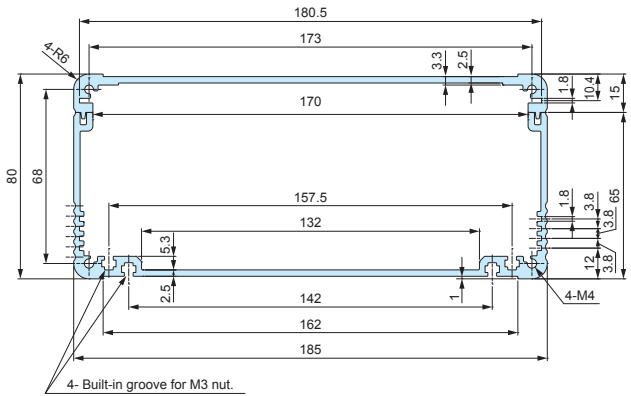

EXP • EXPE • EXPF • EXEF • EXWF20-12-□
EX19-11-□

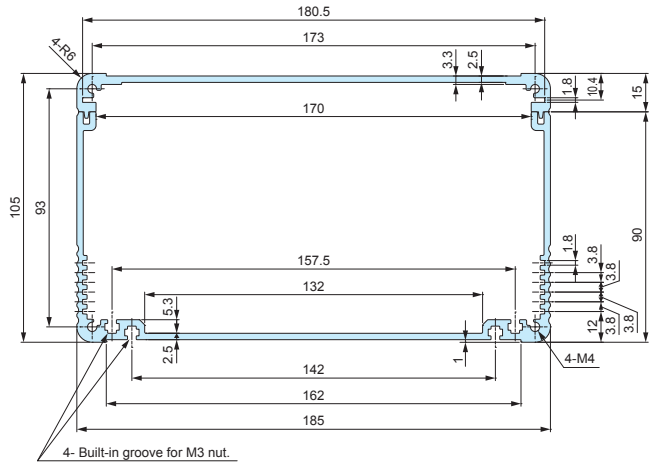

EXP • EXPE24-6-□
EXPF • EXEF • EXWF24-7-□
EX23-5-□

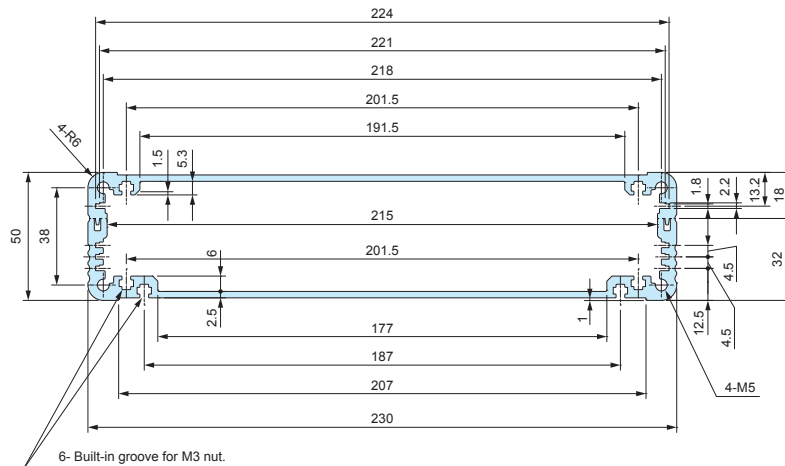

EXP • EXPE • EXPF • EXEF • EXWF • EX top / bottom covers

■ Drawings below are reference examples only.
DXF/DWG/PDF drawings available on our website.

EXP • EXPE • EXPF • EXEF • EXWF24-9-□
EX23-8-□

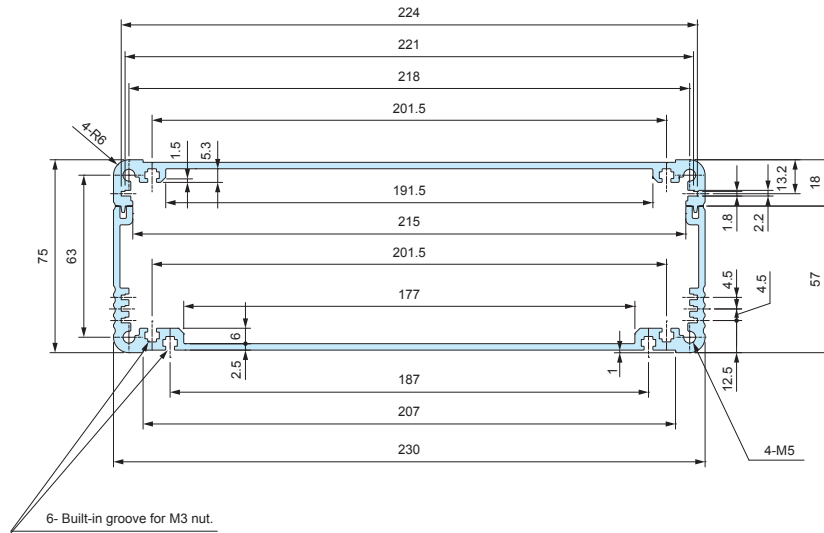

EXP • EXPE24-11-□
EXPF • EXEF • EXWF24-12-□
EX23-10-□

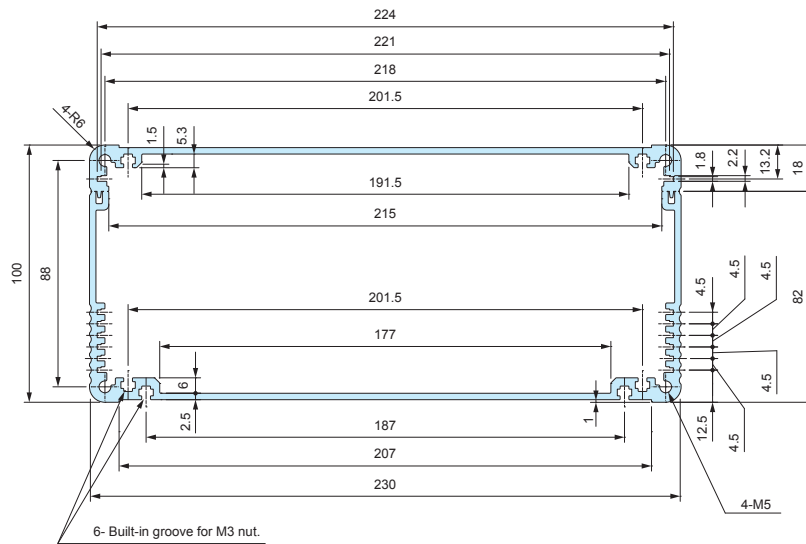

MT-3N

SLIDING NUT for EXP • EXPE • EXW • EXPF • EXEF • EXWF • EX

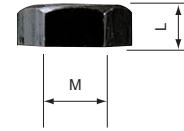
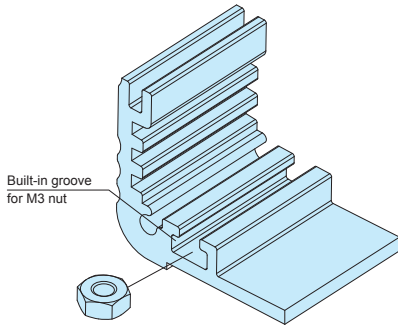

Product no. / Dimensions

Product no.	M	L	Material	Finish	Pack of
MT-3N	3	2.4	Steel	Black trivalent chromate	50

- Sliding nut can be used on all EXP • EXPE • EXW • EXPF • EXEF • EXWF • EX models with width 140mm or larger bottom covers, as well as with width 230mm top covers.

EXEG SERIES

EMC SHIELDING FABRIC-OVER-FOAM GASKET for EXPE • EXEF



- EMC shielding fabric-over-foam gasket for EXPE • EXEF series.

Suitable Enclosure

Product no.	Suitable enclosure
EXEG-2.5	EXPE7-□ • 9-□ • 12-□ • 15-□ / EXEF7-□ • 9-□ • 11-□ • 15-□
EXEG-3.2	EXPE20-□ • 24-□ / EXEF20-□ • 24-□



EMC Shielding Effects

Product no. / Dimensions

Product no.	Φ	Material	Color	Sales unit
EXEG-2.5	2.5	Wire mesh gasket • TPE	Metallic gray	500mm x 1 pc
NEW EXEG-3.2	3.2	Wire mesh gasket • TPE	Metallic gray	500mm x 1 pc

Length tolerance = +/- 10%

APPLICATION EXAMPLE EX series

PREMAIN POWER AMPLIFIER

Product by AY-densi (Japan)



USB EDGE NODE

Product by SHINWA (Japan)

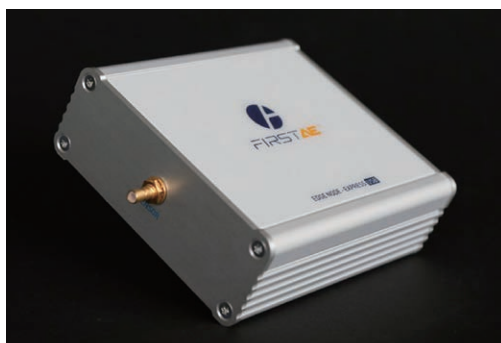



Application Example

- Double shot injection molded feet with soft and well-designed rounded shape.
- Non-slip design with Elastomer (TPE) pad.
- Available in 3 different color patterns.

Technical Data
Max load : 7kg

Components

No.	Part name	Pcs	Material	Color / Finish
1	Front feet	2	PC+ABS UL94V-0, TPE	Black & Black • Navy & Gray • Light gray & Gray
2	Rear Feet	2	PC+ABS UL94V-0, TPE	Black & Black • Navy & Gray • Light gray & Gray
-	Washer head screw	4	Steel M3-6	Black Trivalent chromate
-	Nut	4	Steel M3	Black Trivalent chromate

- Drawings below are reference examples only.
DXF/DWG/PDF drawings available on our website.

Mounting hole (Front)

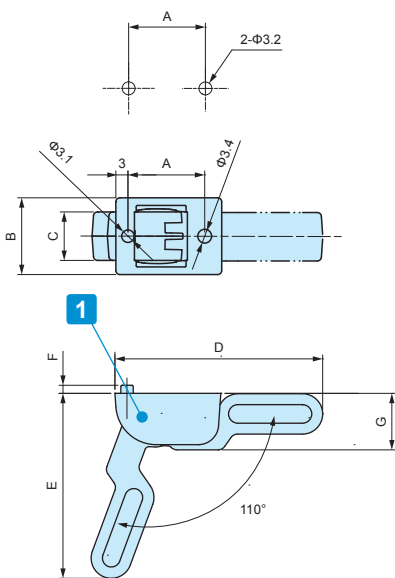

Mounting Hole (Rear)

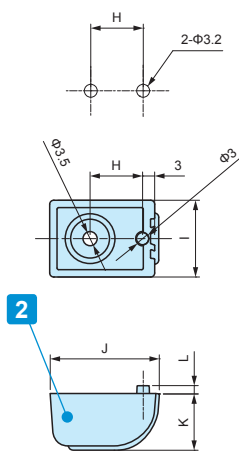

- Possible to install on Built-in groove with M3 nut for all EXP • EXPE • EXW • EX • EXH models with width 185mm or larger bottom covers.
- TLW-70E models are exclusively for width 185mm or larger bottom covers.

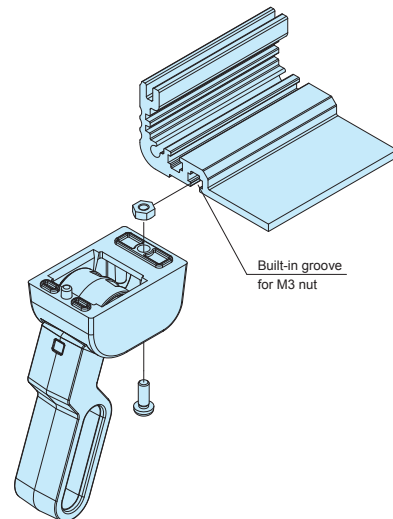

Product no. / Dimensions

Product no.	A	B	C	D	E	F	G	H	I	J	K	L	Color (plastic)	Color (TPE)	Weight (g)
TLW-46BB	19	19	12	51.2	45.9	2	14	13	19	27	14	2	Black	Black	23
TLW-46NG	19	19	12	51.2	45.9	2	14	13	19	27	14	2	Navy	Gray	23
TLW-46LG	19	19	12	51.2	45.9	2	14	13	19	27	14	2	Light gray	Gray	23
NEW TLW-70EBB	30	25	16	75.4	69	3	21.5	20	25	39	21.5	3	Black	Black	59
NEW TLW-70ENG	30	25	16	75.4	69	3	21.5	20	25	39	21.5	3	Navy	Gray	59
NEW TLW-70ELG	30	25	16	75.4	69	3	21.5	20	25	39	21.5	3	Light gray	Gray	59

AFS•AFM SERIES

ALUMINIUM ISOLATION FEET



- The surface treatment and finish allows the feet to exhibit a polished and luxurious feel.
- Non-slip NBR O-ring is present on the underside of the feet.
- Suitable for use in audio devices.

Available in both internal and external screw installation type.

External type / Shot blast finish (AFS series)



The external type is secured via screws from the underside / base of the feet to the enclosure. A thread hole is required for direct securing, while a circular hole is required for lock nut securing.

The shot blast finish provides a high quality surface finish look, and pairing well with various types of enclosure surfaces.

Available in both silver and black.

Internal type / Reflective finish (AFM series)



The internal type is secured via screws from the inside of the enclosure. A circular hole is required for securing into the pre-made threads in the top-side of the feet.

The reflective surface finish adds a high quality touch to the unit, allow it to have a luxurious look.

Available only in Silver.

Accessories (Optional parts)

Product no. / Dimensions

Product no.		D	H	Installation type	C	a	b	Pack of
● Silver	● Black							
AFS20- 8S	AFS20- 8B	20	8	External	Φ3.4	3	9	4
AFS25-10S	AFS25-10B	25	10	External	Φ4.5	4	12	4
AFS30-12S	AFS30-12B	30	12	External	Φ4.5	5	12	4
AFS35-14S	AFS35-14B	35	14	External	Φ4.5	5	12	4
AFS39-16S	AFS39-16B	39	16	External	Φ4.5	5	15	4
AFS44-18S	AFS44-18B	44	18	External	Φ4.5	5	20	4
AFS55-20S	AFS55-20B	55	20	External	Φ5.5	5	20	4
AFM15- 7S	-	15	7	Internal	M3	4	-	4
AFM20- 9S	-	20	9	Internal	M3	5	-	4
AFM25-12S	-	25	12	Internal	M4	7	-	4
AFM30-14S	-	30	14	Internal	M4	8	-	4
AFM35-16S	-	35	16	Internal	M4	10	-	4
AFM39-18S	-	39	18	Internal	M4	10	-	4
AFM44-20S	-	44	20	Internal	M4	10	-	4
AFM55-22S	-	55	22	Internal	M5	15	-	4

AFS • AFM dimensions

■ Drawings below are reference examples only.
DXF/DWG/PDF drawings available on our website.

AFS SERIES

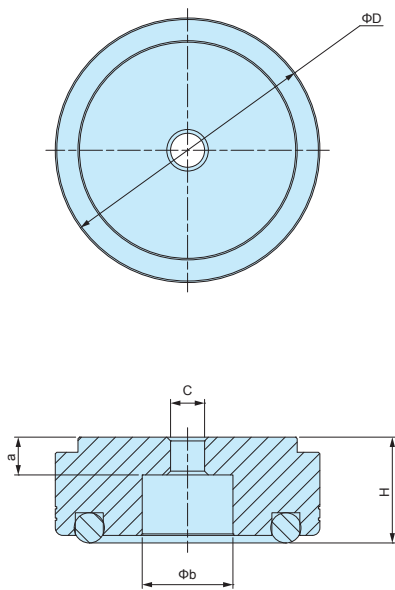

AFM SERIES

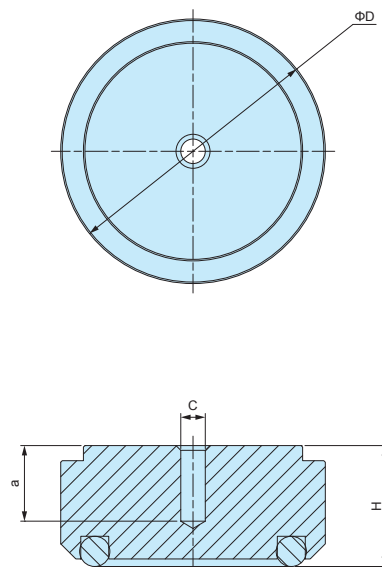

APPLICATION EXAMPLE

